

# FRONT DOOR COURTESY SWITCH

## COMPONENTS

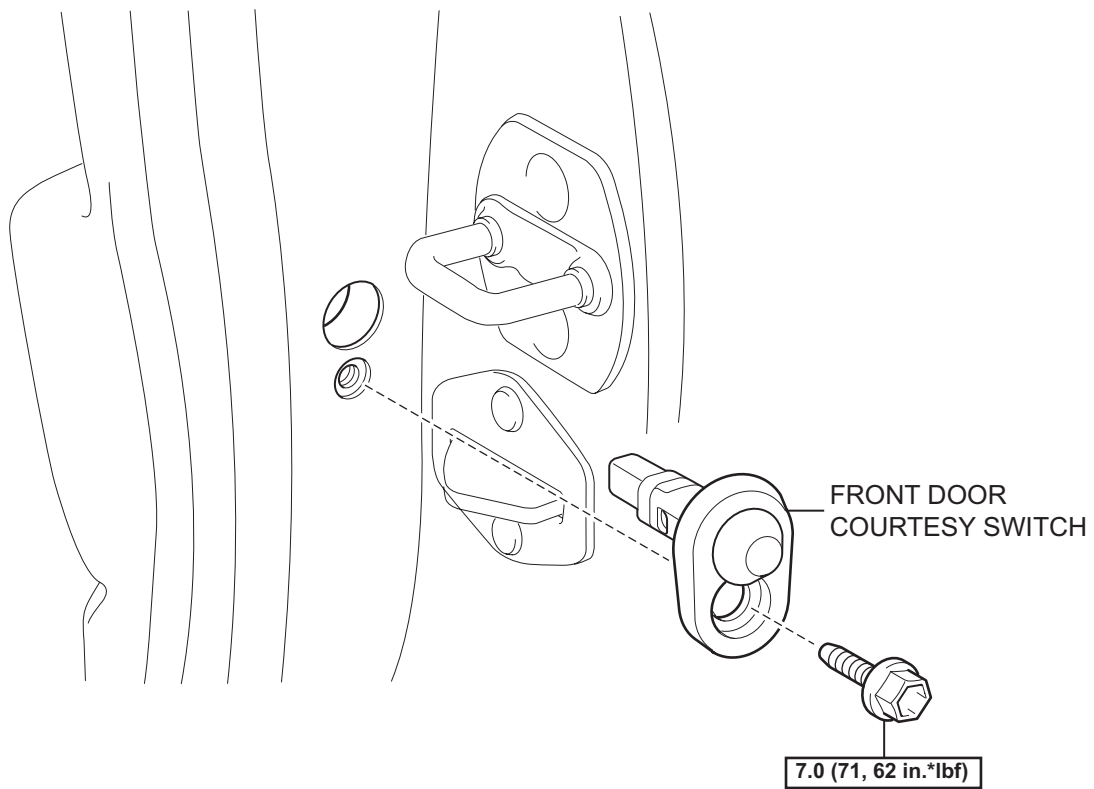

**N\*m (kgf\*cm, ft\*lbf)** : Specified torque

## REMOVAL

### HINT:

- Use the same procedure for both the RH and LH sides.
- The procedure described below is for the LH side.

1. **DISCONNECT CABLE FROM NEGATIVE BATTERY TERMINAL**
2. **REMOVE FRONT DOOR COURTESY SWITCH**
  - (a) Remove the bolt and front door courtesy switch.
  - (b) Disconnect the connector.

