



INSTALLATION INSTRUCTIONS

P/N 75-5043
VEHICLE APPLICATION

2007.5-2009 Dodge Ram 2500, 3500
6.7L Cummins Turbo Diesel

Please Note:

This kit may not fit vehicles with the following **Aftermarket Parts** installed.

- *Body Lift
- *Custom Hood
- *Turbo Upgrade
- *Intercooler Upgrades



TOOLS REQUIRED

- 7, 10 mm Wrench or Socket
- 7/16" Wrench or Socket
- 1/2" Wrench or Socket
- 5/16" Nut Driver or Flat Head screwdriver
- Philips Screwdriver and Pliers or Channel locks

Your S&B Air Filter is factory oiled and ready to use. When serviced, Air Filter P/N KF-1035 will require 87grams of oil on main body plus 17 grams on the power stack (top).

1. With the ignition switched off and the parking brake set, disconnect the negative battery cables on both batteries.



2. Disconnect the electrical connection for the Intake Air Temperature (IAT) Sensor and the Mass Air Flow (MAF) Sensor, then unsnap the wire loom from the tube.

Note : the next step will explain the connector removal.



2a. For the MAF sensor, slide the **red** locking tab up then depress the **black** lever while disengaging the connector. For the IAT sensor just depress the **grey** lever while disengaging the connector.

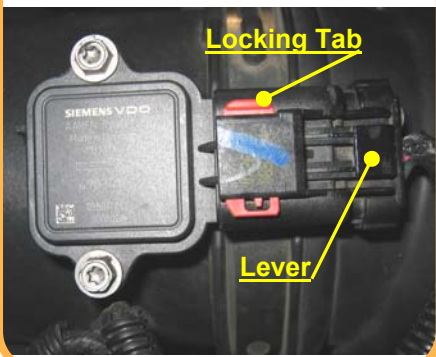

3. Loosen the hose clamp at the turbo inlet, next pinch the spring clamp and slide it down the PCV hose about 1-1/2" then disconnect the silicone hose from the steel piping.



4. Remove the mounting nut on the stock air box.



5. Lift up and out to remove the stock air box assembly from the vehicle.



6. Remove both sensors from the stock air box and set them aside for now.



7. Remove the PCV hose and barb from the stock intake tube. Set aside for now.



8. Install the S&B PCV Grommet (W) into the S&B Intake Tube (C). This is a tight fit to ensure an air tight seal. Use the round shank of a screwdriver and press the grommet in a circular motion against the tube.



Made In The USA

ALL the Flow... None of the Risk!

THE TECHNOLOGY LEADER FOR PERFORMANCE FILTERS AND INTAKE KITS



INSTALLATION INSTRUCTIONS (continued)

9. Apply some lube to the tip of the stock PCV hose barb (removed in step # 7) before inserting it into the S&B Grommet. Hold the grommet from the inside of the tube to prevent it from pushing in during installation.



13. Install the S&B Intake Tube assembly, secure the second # 64 Hose Clamp (A) at the turbo inlet. Slip the PCV hose back onto the steel piping then slide the spring clamp back into position.

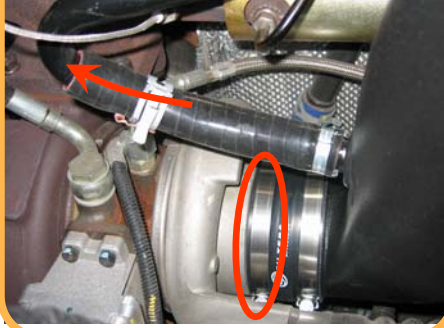

17. Install the S&B Air Filter (J) to the S&B Filter Adapter (K) and secure the # 80 hose clamp (I).



10. Place the S&B Silicone Adapter (B) and both # 64 Hose Clamps (A) onto the S&B Intake Tube (C), secure the first clamp only.



14. Attach the S&B Splash Guard (V) to the S&B Air Box (Q), use the supplied hardware to secure as instructed in the exploded view.



18. Place the filter assembly into the air box, align the filter so as to not gouge or ding the wire mesh as you lower the filter into place. When low enough rotate the Filter Adapter (K) into position and hook the clip into the air box.



11. Place the S&B Hump Adapter (G) over the end of the S&B Intake Tube (C), slide on until nearly flush with the end of the tube. Include both # 88 Hose Clamps (H) but do not tighten at this time.



15. Apply a light amount of grease to the two prongs (pictured above) before installing the S&B Air Box assembly into the vehicle.



19. Install the S&B Clear Lid (P), use the supplied 5/16" Stainless Steel Screws (M) and Rubber Washers (L) along with the 10-24" SS Screws (N) and SS Sealing Washers (O). This will secure the filter adapter to the air box as well.



12. Use the supplied 8-32 SS Screws (F) and Sensor Gaskets (D) and (E), and install the MAF and IAT sensors that you set aside in step #6 into the S&B Intake Tube (C).



16. Secure the S&B Air Box (Q) using the stock nut removed in step # 4.



20. Slide the S&B Hump Adapter (G) over the Filter Adapter (K) and secure both # 88 Hose Clamps (H).



CONTACT S&B FILTERS

(909) 947-0015 Phone (909) 947-0603 FAX
www.sbfilters.com

ALL the Flow... None of the Risk!

THE TECHNOLOGY LEADER FOR PERFORMANCE FILTERS AND INTAKE KITS



INSTALLATION INSTRUCTIONS (continued)

21. Re-route the wiring harness under the S&B Intake Tubes to reconnect the MAF and IAT sensors.

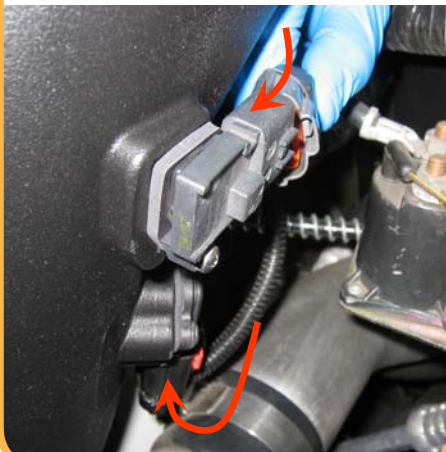

22. Reconnect both batteries. Inspect your installation, make sure kit is properly positioned and all fasteners are secure. Affix the CARB sticker near the intake kit. The Installation is now complete.



PERFORMANCE TESTING

- * Engage parking brake and start your engine. Listen for abnormal noises. If an air leak is detected, re-inspect hoses and connections as they may need to be repositioned and tightened.
- * S&B FILTERS recommends that you keep your OE intake system in the event it is required in the future.
- * In order to maintain your warranty, all connections and components must be checked periodically for alignment and for proper tension on all connections. Failure to do so may void your warranty.
- * Use only S&B FILTERS cleaning and oil products to service your filter. Using any other brand oil and or cleaners on your S&B air filter may void your warranty.

Emission Standards

The California Air Resource Board (CARB) requires that an E.O. identification label be applied to the vehicle in order to pass a smog check inspection when a Performance Intake Kit has been installed. You must place the E.O. label provided on or near the intake kit after installation so that a smog check technician can easily verify the E.O. number.

As of April 2009, S&B has never had a product where CARB denied an exemption request; however, the exemption process with CARB can take as long as 18 months. Check the status of the exemption process by looking up a specific part number at www.sbfilters.com.

The CARB Exemption number and/or status is listed under the Product Details section for each part number. If the status shows as "Pending," CARB has yet to issue an exemption. Products that have not been issued an EO number are street legal in most states, but may not be used on emission controlled vehicles in the state of California and are for off road use only.

If you purchased your kit from S&B Filters directly, we will automatically mail you your Exemption Sticker when it is issued to us. If you purchased your kit from an authorized S&B Filters Dealer, log onto our web site and register to receive your Exemption Sticker.

FILTER CLEANING & OILING

PRECISION CLEANING & OILING KIT

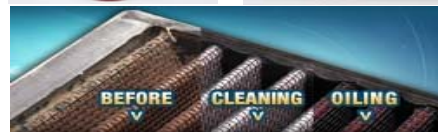

Order online today at www.sbfilters.com
or through your local S&B distributor

CONTACT S&B FILTERS

(909) 947-0015 Phone (909) 947-0603 FAX
www.sbfilters.com

ALL the Flow... None of the Risk!

THE TECHNOLOGY LEADER FOR PERFORMANCE FILTERS AND INTAKE KITS



EXPLODED VIEW

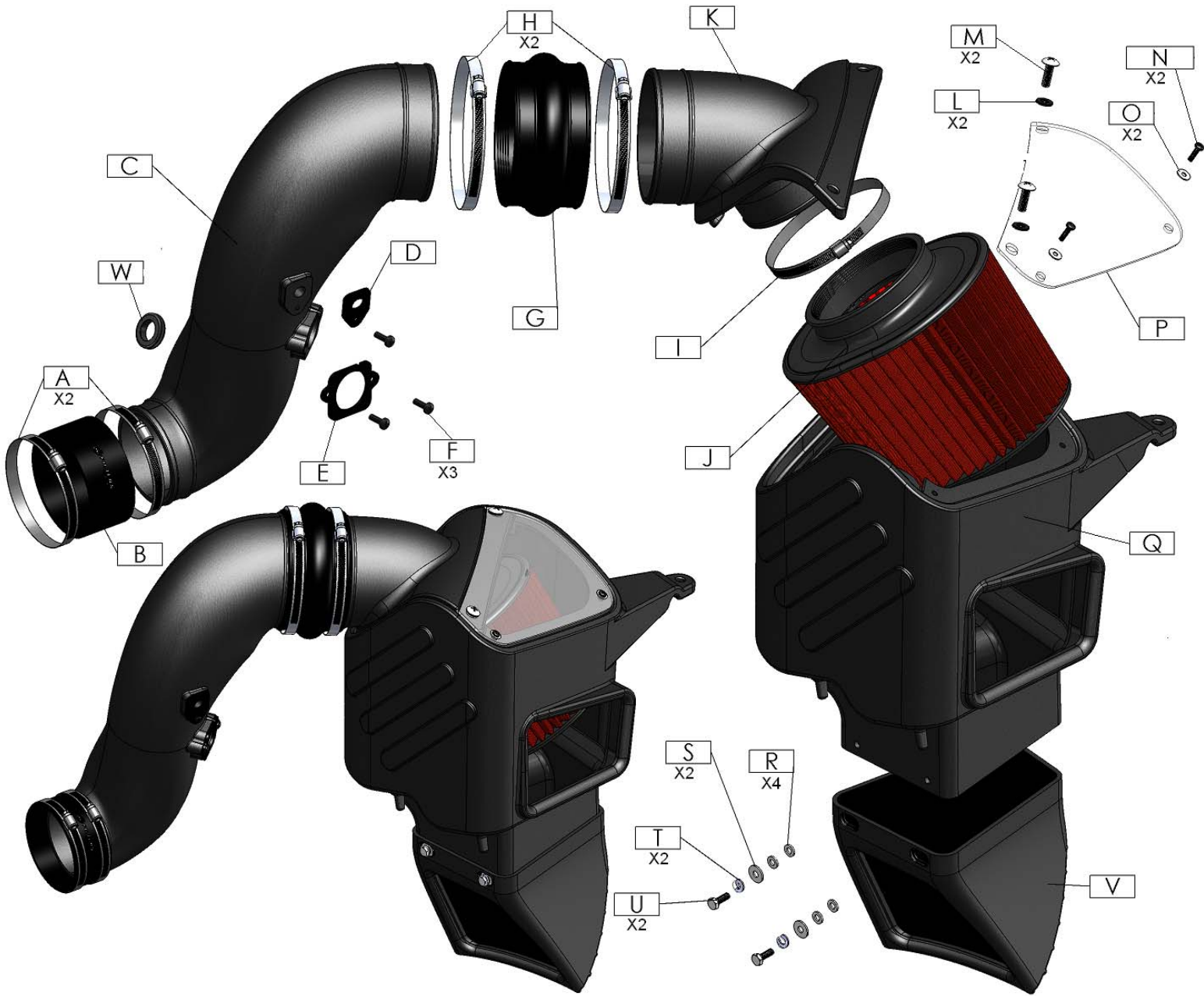

S&B P/N 75-5043 PARTS LIST

QTY	DESCRIPTION	QTY	DESCRIPTION
1	(Q) Air Box	2	(N) 10/24 SS Screw
1	(P) Clear Lid	2	(O) 10/24 SS Sealing Washer
1	(K) Filter Adapter Tube	3	(F) 8-32 x 5/8" SS Screw
2	(M) 5/16-18 SS Screw	1	(O) S&B Air Filter
1	(C) Intake Tube	1	(D) IAT Sensor Gasket
1	(G) Hump Adapter	2	(H) # 88 Hose Clamp
2	(A) # 64 Hose Clamp	1	(I) #80 Hose Clamp
2	(L) Rubber Washer	2	(U) 1/4" x 1" Bolt
2	(T) 1/4" Lock Washer	2	(S) 1/4" Flat Washer
4	(R) M8 Spacer	1	(B) Silicone Adapter
1	(V) Splash Guard	1	(E) MAF Sensor Gasket
		1	(W) PCV Grommet

CONTACT S&B FILTERS

(909) 947-0015 Phone (909) 947-0603 FAX
www.sbfilters.com

ALL the Flow... None of the Risk!

THE TECHNOLOGY LEADER FOR PERFORMANCE FILTERS AND INTAKE KITS