



Equipped with *AEM DRYFLOW* Filter
No oil Required!

Kit Part Number: 21-9210

1994-2002 Dodge Ram 5.9L Cummins Diesel CARB EO # D-392-29

Brute Force HD Intake Systems that are pending an Executive Order number (EO#) relating to exemptions under Section 27156 of the Vehicle Code from the California Air Resource Board (CARB) are for off-road use only in California, which may never be used on public highways.

© 2008, Advanced Engine Management, Inc. AEM is a registered trademark of Advanced Engine Management, Inc. All Rights Reserved.



Advanced Engine Management Inc.
2205 126th Street, Unit A
Hawthorne, CA 90250
Phone: 310.484.2322
<http://www.aempower.com>

THE INFORMATION CONTAINED IN THIS DRAWING IS THE SOLE PROPERTY OF
ADVANCED ENGINE MANAGEMENT, INC. ANY REPRODUCTION IN PART OR WHOLE WITHOUT
THE WRITTEN PERMISSION OF ADVANCED ENGINE MANAGEMENT, INC. IS PROHIBITED

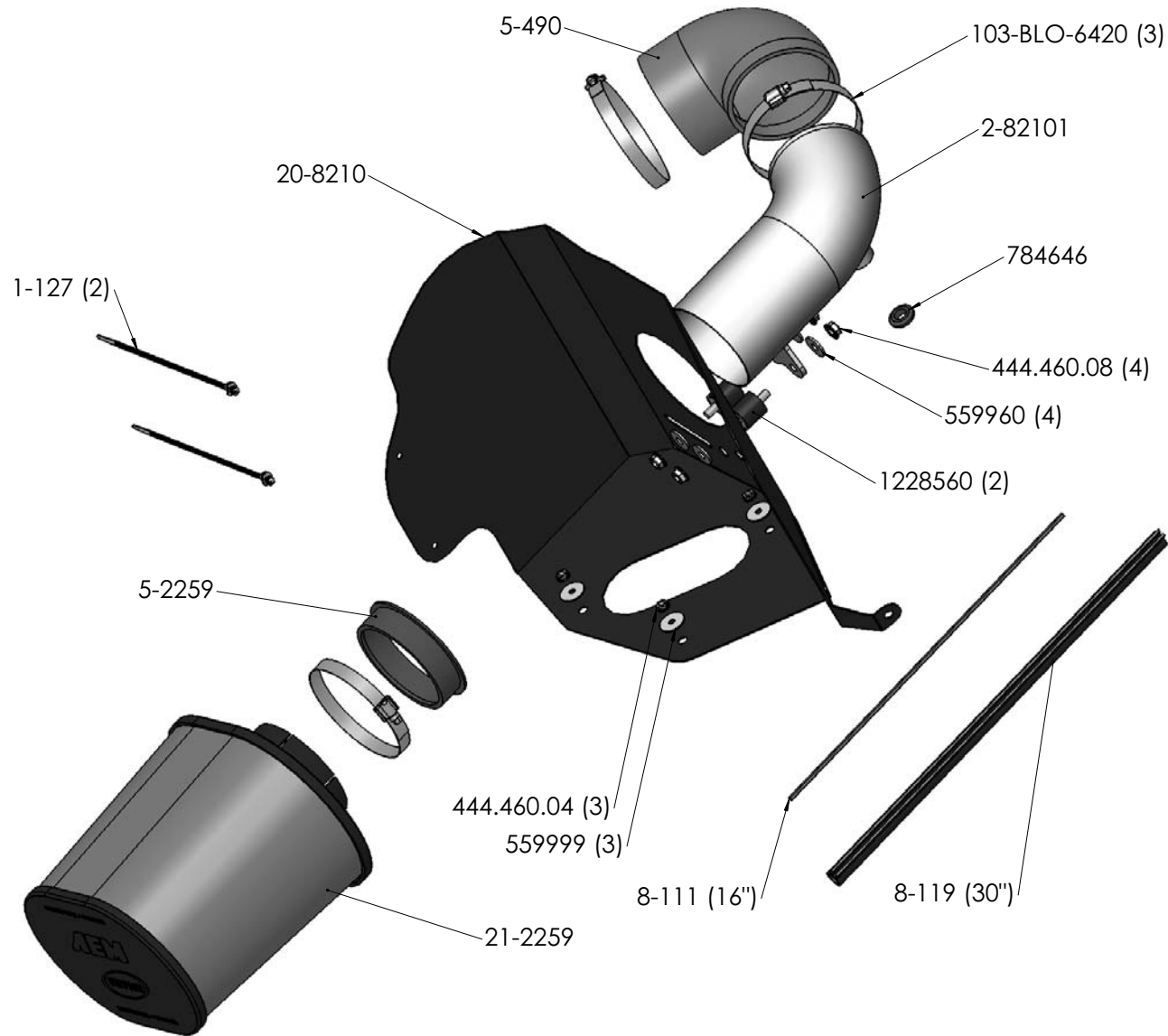

Bill of Materials

Qty.	Part Description	Part Number	Qty.	Part Description	Part Number
1	Instructions	10-8210	1	Grommet	784646
1	Inlet Pipe	2-82101	3	#64 Hose Clamp	104-BLO-6420
1	Heatshield	20-8210	3	6mm Washer	559999
2	8mm rubber mount	1228560	3	6mm Serrated Nut	444.460.04
30	Rubber Gasket	8-119	2	8" Tree Mount Zip-Tie	1-127
16	Rubber Edge Trim	8-111	1	4" 90 Degree Elbow	5-490
1	Filter Adaptor	5-2259			
4	8mm Washer	559960			
4	8mm Serrated Nut	444.460.08			
1	9" Brute Force HD Filter	21-2259D			

1. Preparing Vehicle

- a) Make sure vehicle is parked on a level surface.
- b) Set parking brake.
- c) If engine has run in the past two hours let it cool down.
- d) Disconnect negative battery terminals.

Recommended Tools:

- 5/16" Nut Driver
- 10mm & 13mm Socket
- Ratchet
- Extension
- 10mm Wrench

Installation Time: 1.5 hours

2. Removal of Stock System



a) Stock intake system.



b) Loosen the hose clamps securing the flexible inlet hose between the turbo inlet and the air filter housing. Remove the hose.



c) Release the four retaining clips securing the air filter housing lid to the lower housing. Remove the lid.



d) Remove the snorkel from the lower air filter housing by squeezing the middle together while pulling towards center of the vehicle.



e) Loosen the three plastic nuts securing the lower air filter housing to the vehicle. Remove the housing by gently lifting up.



f) Remove the factory air filter restriction gauge from the stock air filter housing lid.

3. Installation of Brute Force HD Intake System

- a)** When installing the intake system, DO NOT completely tighten the hose clamps or mounting tab hardware until instructed to do so.
- b)** Before installing intake pipe, be sure to check for packaging material in the intake pipe.



c) Stock intake system removed.



d) Remove the 13mm bolt from the inner fender behind the passenger side battery as shown.



e) Install the two supplied tree mount zip-ties into the two holes on heat shield as shown.

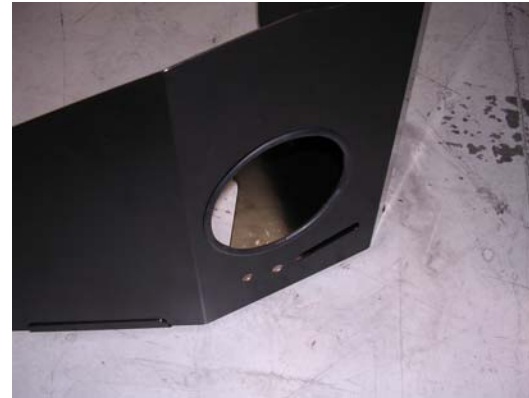

f) Install the supplied rubber edge trim to the hole on the heat shield. Trim to fit.

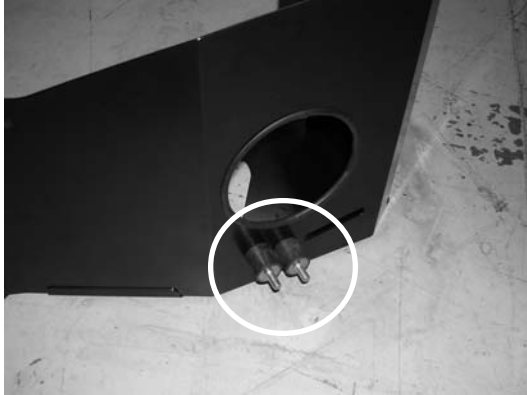

g) Install the two rubber mounts into the two holes on the heatshield using the supplied M8 washers and nuts. Do not tighten the nuts.

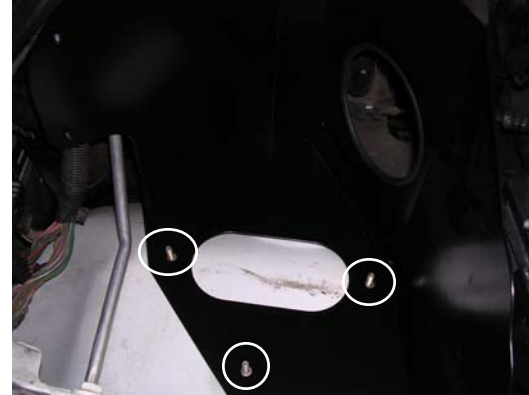

h) Carefully place the heat shield in the engine compartment aligning the three holes on the bottom with the studs in the inner fender.



i) Align the small mounting tab with hole where the bolt was removed in step 3c. Reinstall the bolt, securing the heat shield to the inner fender.

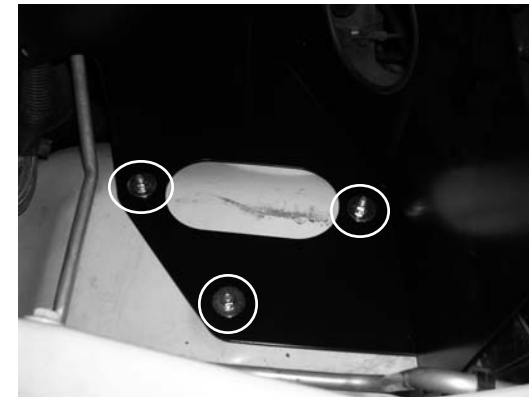

j) Install the three supplied M6 nuts and washers onto the studs from step 3h. Once heat shield is aligned properly, fully tighten the nuts and the bolt from step 3i.

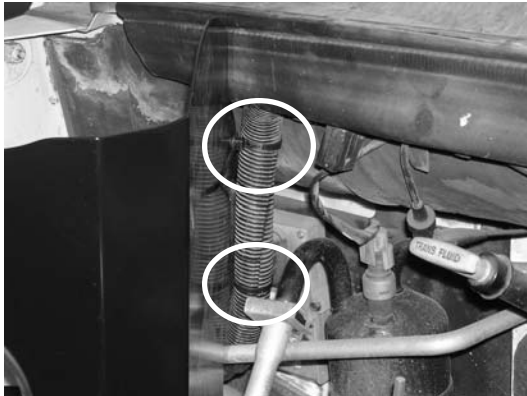

k) Secure the two previously installed zip-ties to the main wiring harness by the vehicle firewall. Trim the excess plastic strip.



l) Loosely install the 90 degree coupler onto the short end of the pipe as shown. Use a #64 hose clamp but do not tighten it down on the pipe.



m) Using either the factory grommet or the supplied grommet, install the filter restriction gauge into the nipple on the pipe as shown.



n) Install the intake pipe by sliding the long end of the coupler over the turbo inlet while aligning the mounting bracket on the pipe with the two rubber mounts on the heat shield.



o) Secure the coupler to the turbo-charger using a #64 hose clamp but do not fully tighten the clamp yet.



p) Secure the pipe mounting bracket to the heat shield using the supplied M8 washer and bolt.

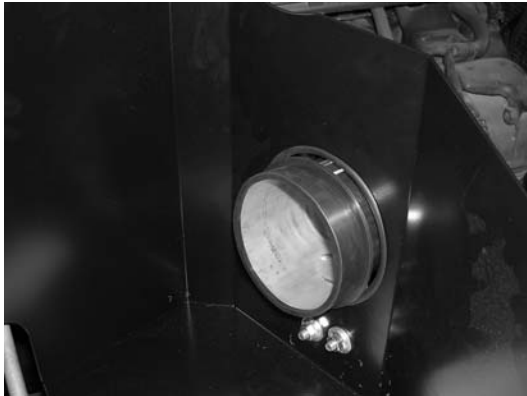

q) Install the supplied air filter adapter by stretching it over the end of the pipe.



r) Check that the pipe is centered in the heat shield hole. Once confirmed, tighten the nuts on the bracket and the hose clamps on the pipe and turbo.

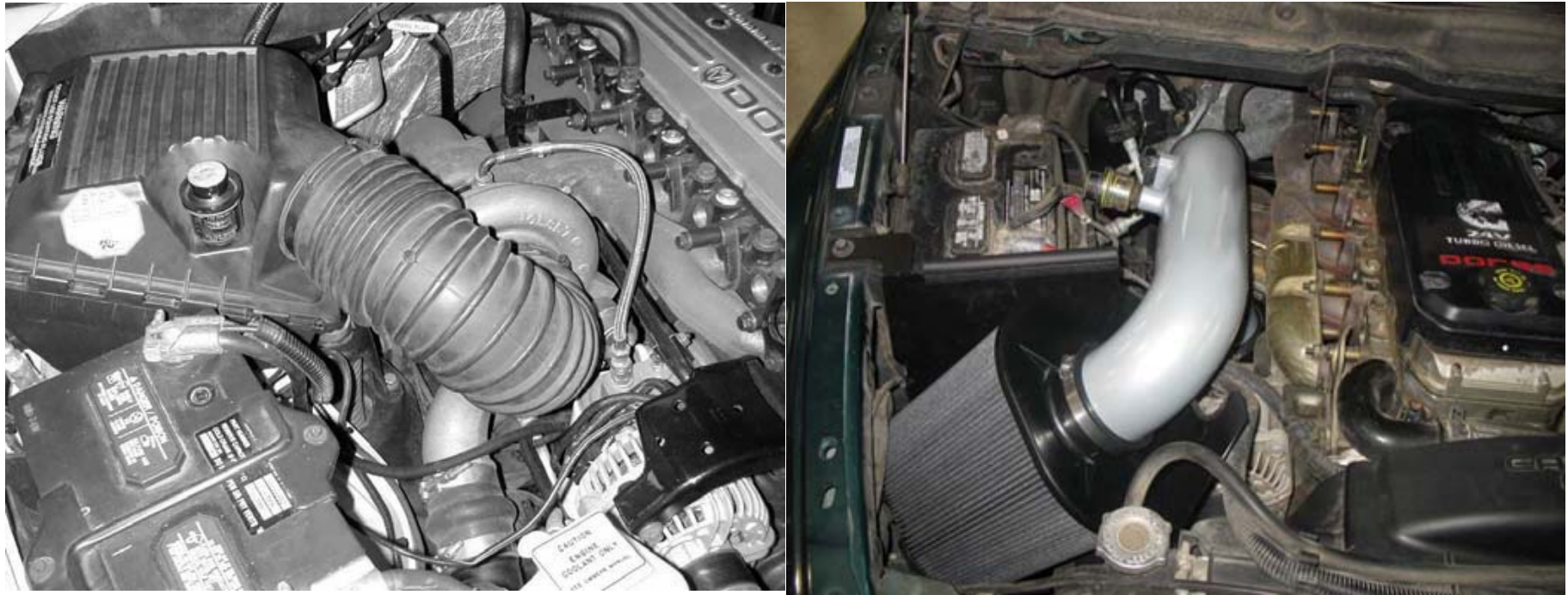

s) Install the Brute Force HD Dryflow filter onto the filter adapter. Rotate the filter until it is not touching any part of the vehicle and secure it using the remaining #64 clamp.

**Before****After**

4. Re-assemble Vehicle

- a) Position the inlet pipe for best fitment. Be sure that the pipe or any other components do not contact any part of the vehicle they are not supposed to. Tighten the rubber mounts, all bolts and hose clamps.
- b) Install the rubber gasket onto the top edge of the heat shield and trim the excess. This seals the hood to the heat shield. Check for proper hood clearance. Readjust pipes if necessary and retighten them.
- c) Inspect the engine bay for any loose tools and check that all fasteners that were moved or removed are properly tight.
- d) Reconnect negative battery terminals and start the engine. Let car idle for 3 minutes. Perform a final inspection before driving vehicle.

5. Service and Maintenance

- a) It is recommended that you service your AEM Dryflow filter every 20,000 miles for optimum performance. Use AEM Dryflow cleaning kit part #21-110.
- b) Use aluminum polish to clean your polished AEM Brute Force HD intake pipe.
- c) Use window cleaner to clean your powder coated AEM Brute Force HD intake pipe.

NOTE: DO NOT USE ALUMINUM POLISH ON A POWDER COATED AEM BRUTE FORCE HD INTAKE!

For technical inquires
e-mail us at
tech@aempower.com
or
call us at
310.484.2322 Option #3