

# FRONT NO. 1 SPEAKER

## COMPONENTS

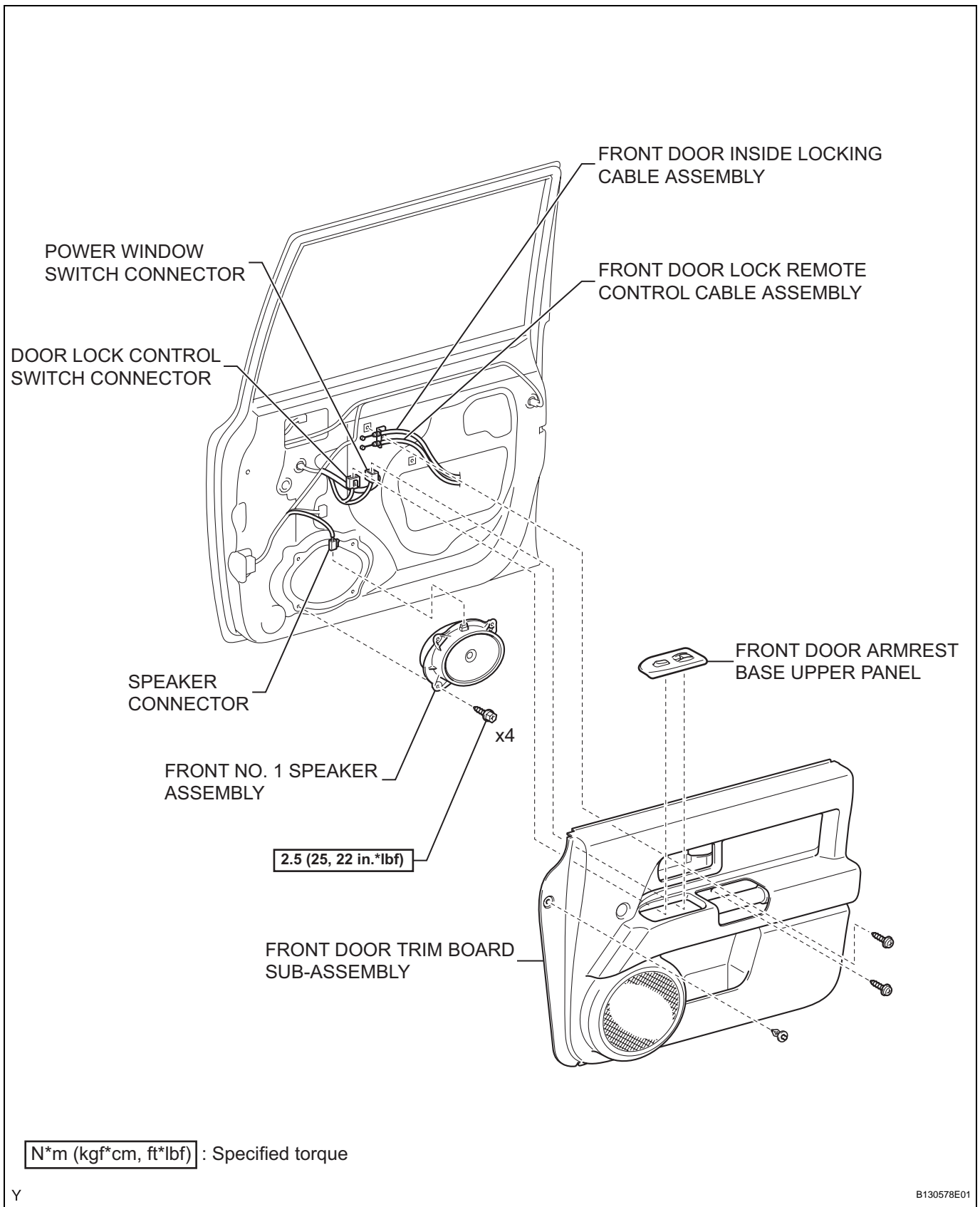

AV

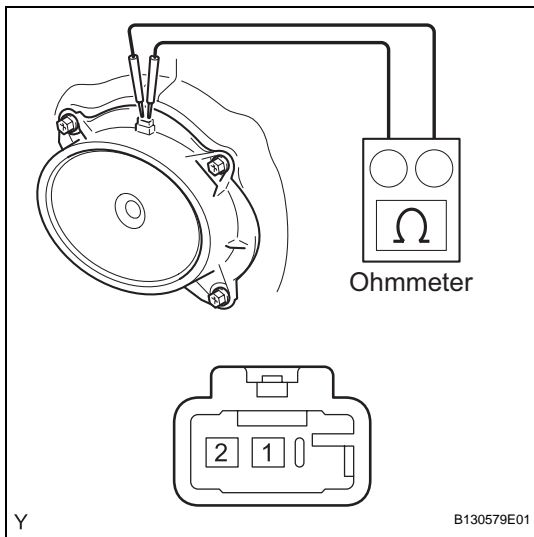

## ON-VEHICLE INSPECTION

### 1. INSPECT FRONT NO. 1 SPEAKER ASSEMBLY

#### HINT:

Remove interior parts so that the front No. 1 speaker can be seen.

- (a) Check the speaker installation.

#### OK:

**The speaker is securely installed.**

If the result is not as specified, reinstall the front No. 1 speaker.

- (b) Visually check the speaker.

#### OK:

**The cone paper of the speaker is not torn.**

If the result is not as specified, replace the front No. 1 speaker.

- (c) Check the resistance.

- (1) Disconnect the speaker connector.

- (2) Using an ohmmeter, measure the resistance between the terminals.

#### Standard resistance

Tester Connection	Specified Condition
1 - 2	Approximately 4 Ω

If the result is not as specified, replace the front No. 1 speaker.