



AIRCHARGER™

HIGH-FLOW INTAKE KITS



INSTALLATION INSTRUCTIONS

63-9034

TOYOTA

2010 FJ Cruiser, 4Runner

V6-4.0L

NOTE: This kit was not designed to fit vehicles with a body lift.

TOOLS NEEDED:

- Ratchet
- Extension
- 13mm socket
- 12mm socket
- 10mm socket
- 10mm wrench
- 4mm allen wrench
- 3mm allen wrench
- Pliers
- Flat blade screw driver

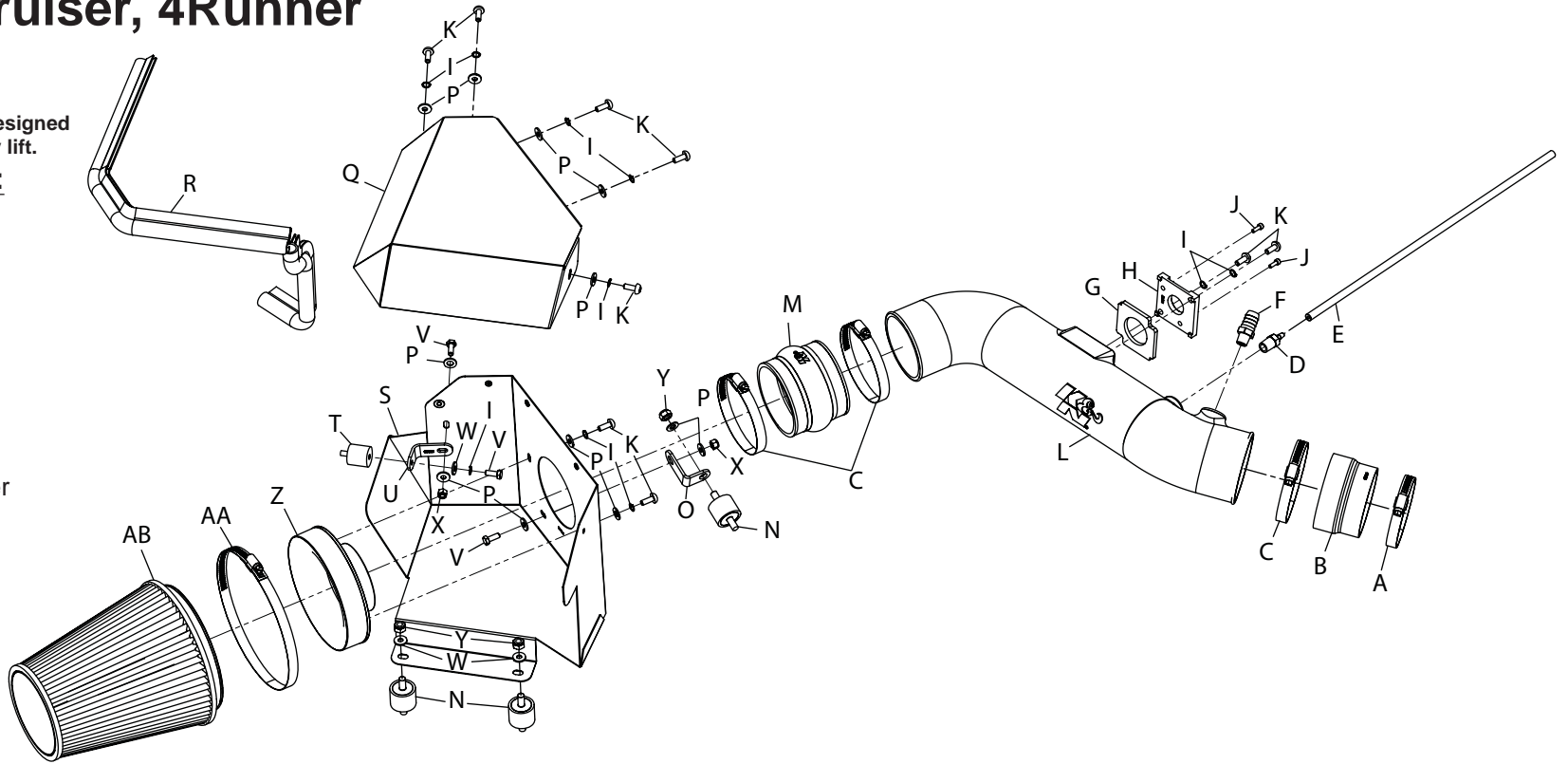

PARTS LIST:

Description	Qty.	Part #
A Hose Clamp #48	1	08601
B 3.25"ID TO 3.50"ID X 2.25"L	1	084091
C Hose Clamp #56	3	08620
D Vent; Strt, 5/8 Barbed 1/4"	1	08911
E Hose; 4MM ID X 18" L	1	08153
F Vent; Strt, 3/16 Barbed 1/4"NPT	1	080021
G Gasket; 57-1003, 3/16 Poron	1	09074
H Adapter; 63-9034 Mass Air	1	21521
I Washer; 1/4" Lock, ZN	10	08198
J Bolt; M4-0.07 8MM, A/H CAP	2	07733
K Bolt; M6 X 1.00 X 16MM Bttnhd	9	07730
L Intake Tube (HX)	1	087238
M Hose; 3-1/2" ID X 3" L	1	084057
N Stud; M/M 8MM X 1.25 - 1"L	3	070227
O Bracket; 57-1506, "L" FIN.	1	08022
P Washer; 1/4"ID X 5/8"OD	12	08275
Q Heat Shield Lid	1	074068
R Edge Trim (30")	1	102489
S Heat Shield	1	074067
T Stud; M6 X 1, 1" T, M/F	1	02033
U Bracket; 63-1015, "L",	1	070712
V Bolt; 6MM-1.00 X 16MM	3	07812
W Washer; 8MM, Flat, SS	3	08272
X Nut; 6MM Nylock, Hexhead	2	07512
Y Nut; 8MM Nylock, SS	3	07502
Z Adapter; 6" Filter 3.5"	1	21512-1
AA Hose Clamp #104	1	08697
AB Air Filter	1	RF-1044XD

NOTE: FAILURE TO FOLLOW INSTALLATION INSTRUCTIONS AND NOT USING THE PROVIDED HARDWARE MAY DAMAGE THE INTAKE TUBE, THROTTLE BODY AND ENGINE.

TO START:

1. Turn off the ignition and disconnect the negative battery cable.
NOTE: Disconnecting the negative battery cable erases pre-programmed electronic memories. Write down all memory settings before disconnecting the negative battery cable. Some radios will require an anti-theft code to be entered after the battery is reconnected. The anti-theft code is typically supplied with your owner's manual. In the event your vehicles' anti-theft code cannot be recovered, contact an authorized dealership to obtain your vehicles anti-theft code.



2. Lift up the engine cover to dislodge it from the mounting grommets and then remove the cover from the vehicle.



3. Disconnect the mass air sensor electrical connection and then unhook the wiring harness from the air box.
NOTE: The wiring harness attaches in three locations.

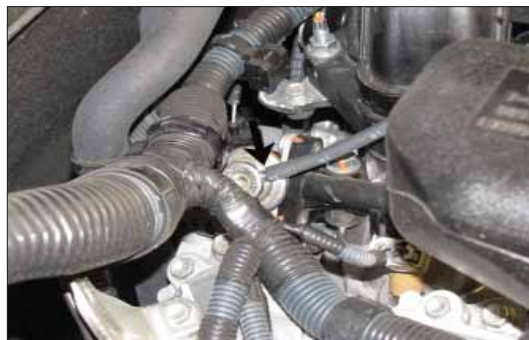

4. Unhook the fuel pressure vent line from the fuel pressure regulator.



5. Disconnect the crank case vent hose from the stock intake tube.



6. Remove the bolt which secures the tube mounting bracket to the engine valve cover.



7. Loosen the hose clamp which secures the intake tube to the throttle body.



8. Release the four clips which secure the upper air box to the lower air box and then remove the intake tube and upper air box from the vehicle.

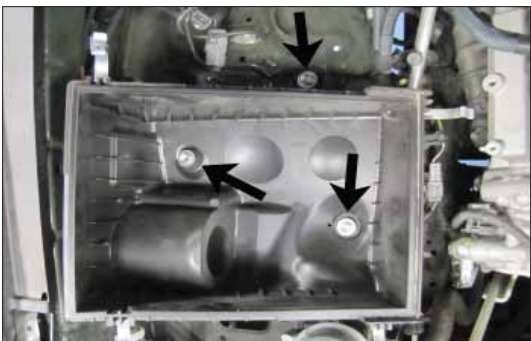

9. Loosen and remove the three bolts securing the lower air box and then remove the lower air box from the vehicle.

NOTE: K&N Engineering, Inc., recommends that customers do not discard factory air intake.

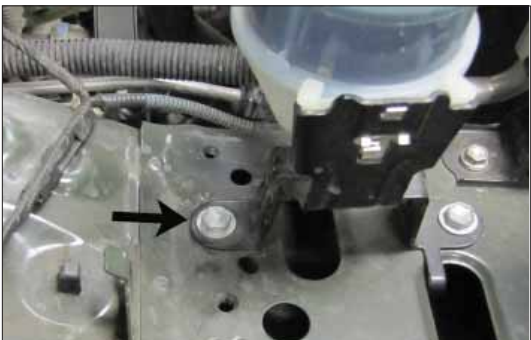

10. Remove the rear P/S reservoir mounting bolt shown.



11. Install one of the provided 8mm rubber mounted studs to secure the P/S reservoir as shown.



12. Install the two remaining 8mm rubber mounted studs in the locations shown.



13. Install the 6mm rubber mounted stud into the inner fender location shown.

NOTE: On some models, a horn may be attached in this location.

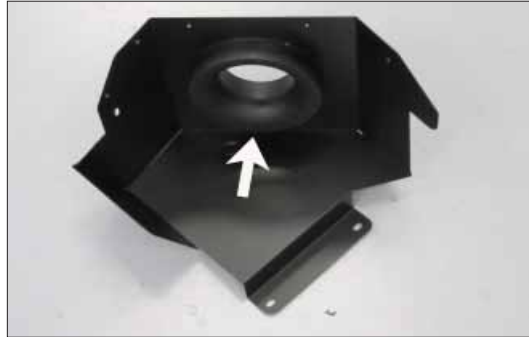

14. Install the filter adapter into the heat shield and secure with the provided hardware.

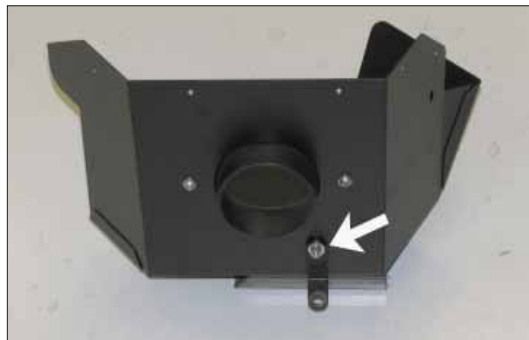

15. Install the provided mounting bracket (070712) onto the heat shield and secure with the provided hardware.



16. Install the provided mounting bracket (08022) onto the heat shield and secure with the provided hardware.

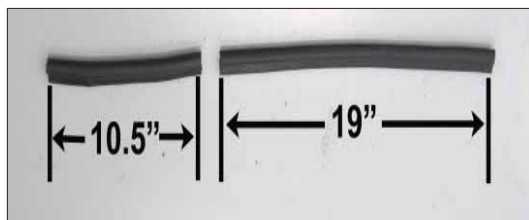

17. Cut the provided edge trim into two lengths as shown. One section is to be 10.5" long and one section is to be 19" long.

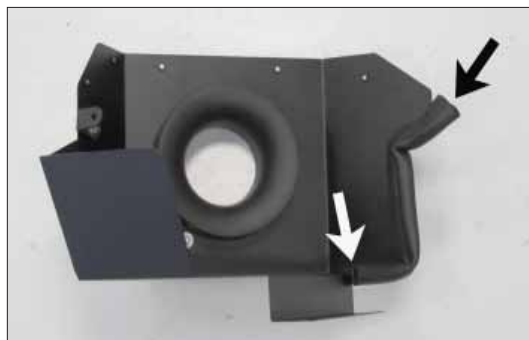

18. Install the 10.5" long piece onto the heat shield as shown.



19. Set the heat shield onto the rubber mounted studs and secure with the provided hardware.

NOTE: On models that had a horn attached in this location, be sure to reattach the horn between the heat shield bracket and rubber mounted stud.



20. Install the provided silicone hump hose (084057) onto the filter adapter and secure with the provided hose clamp.



21. Install the provided silicone step hose (084091) onto the throttle body and secure with the provided hose clamp.



22. Install the provided gasket onto the K&N mass air sensor adapter as shown.



23. Remove the screws which secure the mass air sensor to the factory air box and then remove the mass air sensor from the air box.



24. Install the mass air sensor into the K&N mass air sensor adapter and secure with the provided hardware.



25. Install the mass air sensor assembly into the K&N intake tube and secure with the provided hardware.

NOTE: Be sure to place the mass air sensor with the opening towards the filter end of the tube as in photo.



26. Install the 5/8 vent fitting into the K&N intake tube as shown.



27. Install the 3/16 vent fitting into the K&N intake tube as shown.



28. Install the K&N intake tube into hump hose at the filter adapter and then into the silicone hose at the throttle body, align the tube for proper fit and then tighten the hose clamps.



29. Connect the crank case vent line to the 5/8 vent fitting and secure with the factory spring clamp.



30. Connect the provided fuel pressure vent line to the fuel pressure regulator and then connect the open end to the 3/16 vent fitting in the K&N intake tube.



31. Install the K&N air filter onto the filter adapter and secure with the provided hose clamp.



32. Install the remaining 19" piece of edge trim onto the heat shield cover as shown.



33. Install the heat shield cover onto the heat shield and secure with the provided hardware.

NOTE: Use of the heat shield cover is not mandatory; it is recommended that the cover is used during conditions of heavy moisture such as water crossings where water can be thrown from the engine fan.



34. Reinstall the engine cover onto the engine.



35. Reconnect the mass air sensor electrical connection.



36. Reconnect the vehicle's negative battery cable. Double check to make sure everything is tight and properly positioned before starting the vehicle.

37. It will be necessary for all K&N® high flow intake systems to be checked periodically for realignment, clearance and tightening of all connections. Failure to follow the above instructions or proper maintenance may void warranty.

ROAD TESTING:

1. Start the engine with the transmission in neutral or park, and the parking brake engaged. Listen for air leaks or odd noises. For air leaks secure hoses and connections. For odd noises, find cause and repair before proceeding. This kit will function identically to the factory system except for being louder and much more responsive.
2. Test drive the vehicle. Listen for odd noises or rattles and fix as necessary.
3. If road test is fine, you can now enjoy the added power and performance from your kit.
4. K&N Engineering, Inc., suggests checking the air filter element periodically for excessive dirt build-up. When the element becomes covered in dirt (or once a year), service it according to the instructions on the Recharger® service kit, part number 99-5050 or 99-5000.

STREET LEGAL IN MOST STATES

**NOT LEGAL FOR USE IN CA & OTHER STATES
ADOPTING CA EMISSIONS STANDARDS**

See our catalog or knfilters.com for CARB status on each part for a specific vehicle

* FREE K&N® decal To register your warranty, please see us online at knfilters.com/register. FREE K&N® decal *

• 1455 CITRUS ST., P.O. BOX 1329, RIVERSIDE, CA., U.S.A. 92502 • TECH SERVICE 800-858-3333 • FAX 951-826-4001
• e-mail: tech@knfilters.com • WWW: <http://www.knfilters.com>