

# THROTTLE BODY COMPONENTS

ES

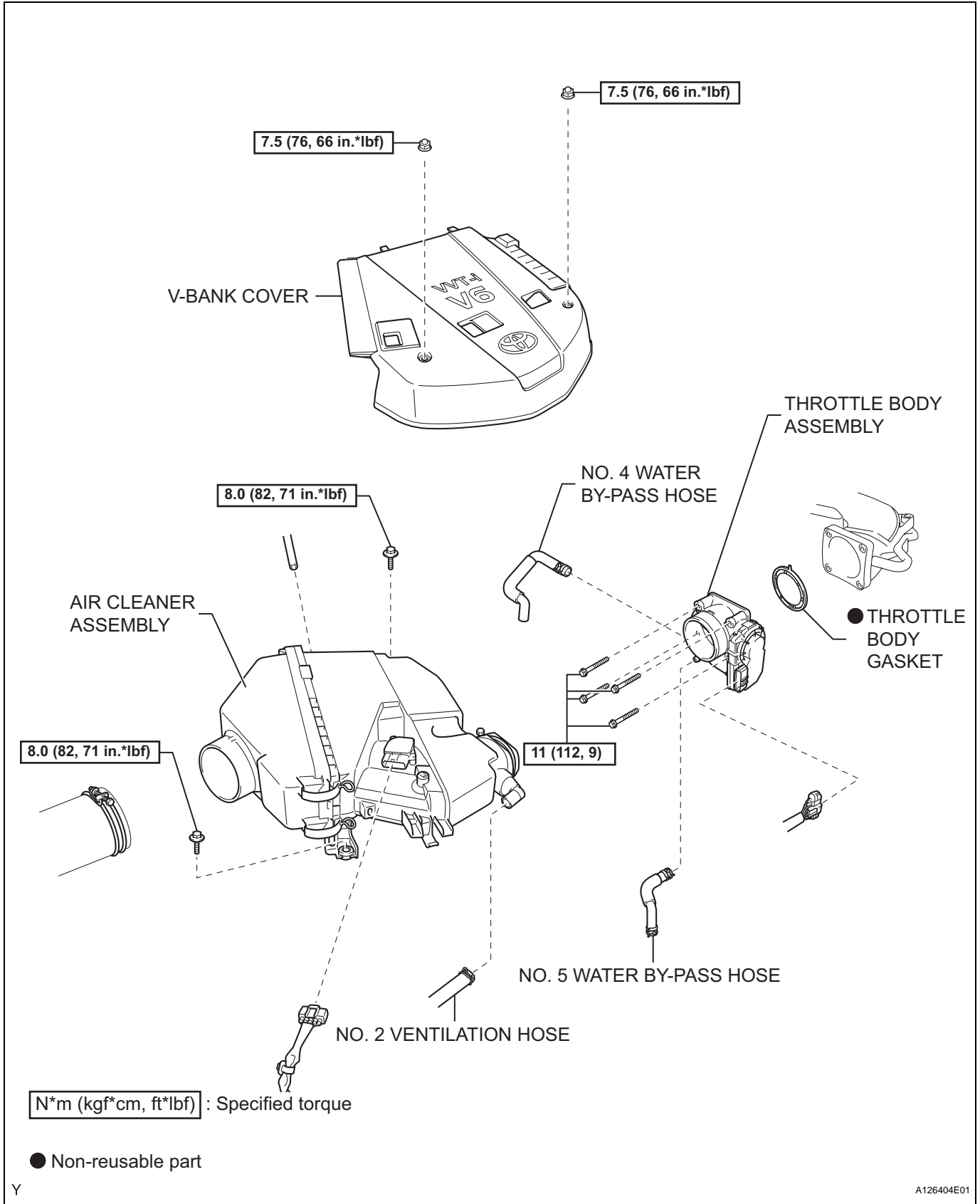

## ON-VEHICLE INSPECTION

### 1. INSPECT THROTTLE BODY ASSEMBLY

- (a) Listen to the throttle control motor operating sounds.
  - (1) Turn the ignition switch to ON.
  - (2) When pressing the accelerator pedal, listen to the running sound of the motor. Make sure no friction noises come from the motor.  
If friction noises occur, check the throttle body, wire harness and ECM.

- (b) Check the throttle position sensor.
  - (1) Turn the ignition switch to ON.
  - (2) Turn the intelligent tester ON.
  - (3) Start the engine and warm it up.
  - (4) Select the following menu items: DIAGNOSIS / ENHANCED OBD II / DATA LIST / PRIMARY / THROTTLE POS .
  - (5) Depress the accelerator pedal. When the throttle valve is fully open, check that the THROTTLE POS value is within the specification.

**Standard:**

**60% or more**

**NOTICE:**

**When checking the standard throttle valve opening percentage, the transmission should be in the neutral position.**

If the result is not as specified, check the throttle body, wire harness and ECM.

