

# AIR CONDITIONING UNIT

## COMPONENTS

AC

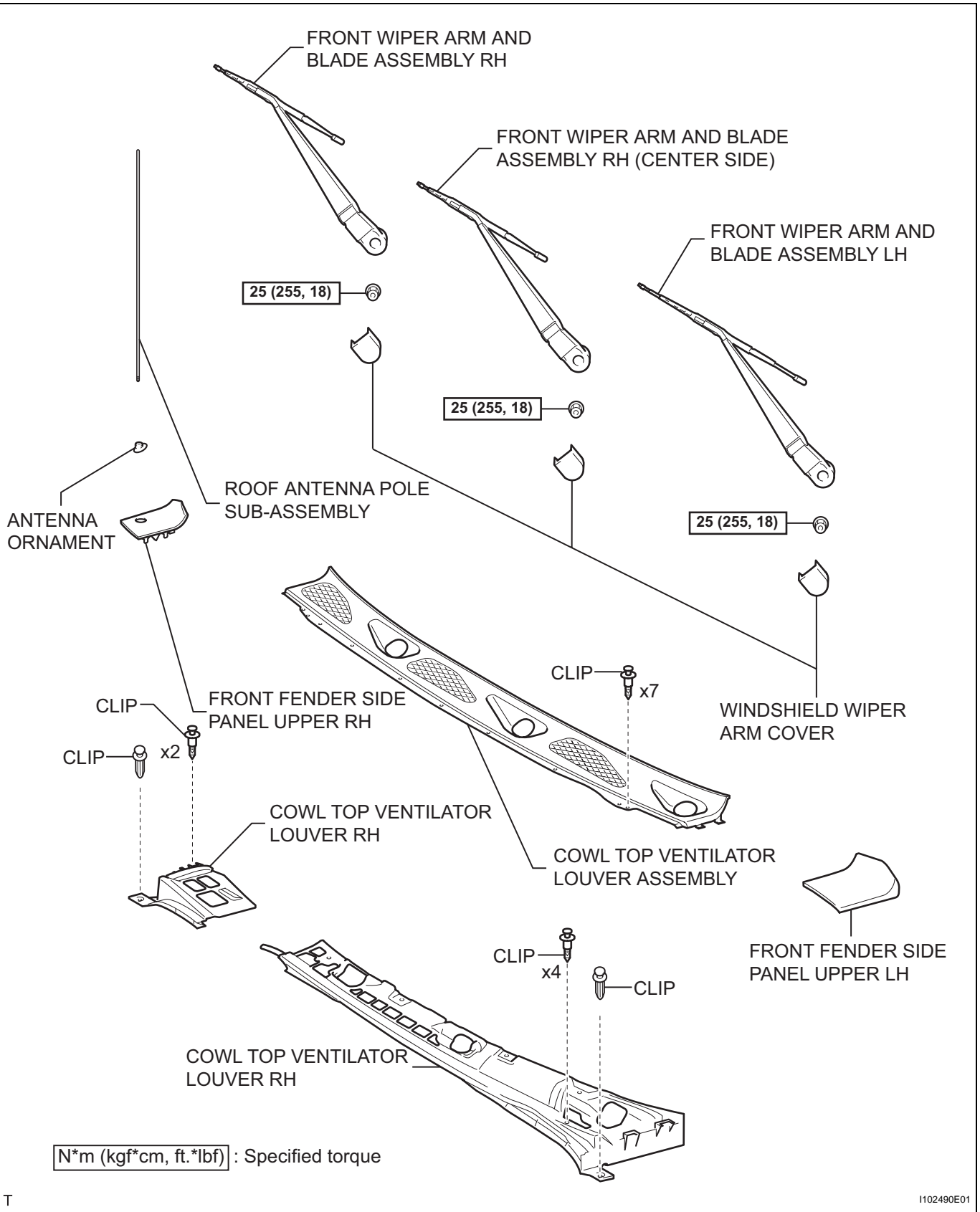

AC

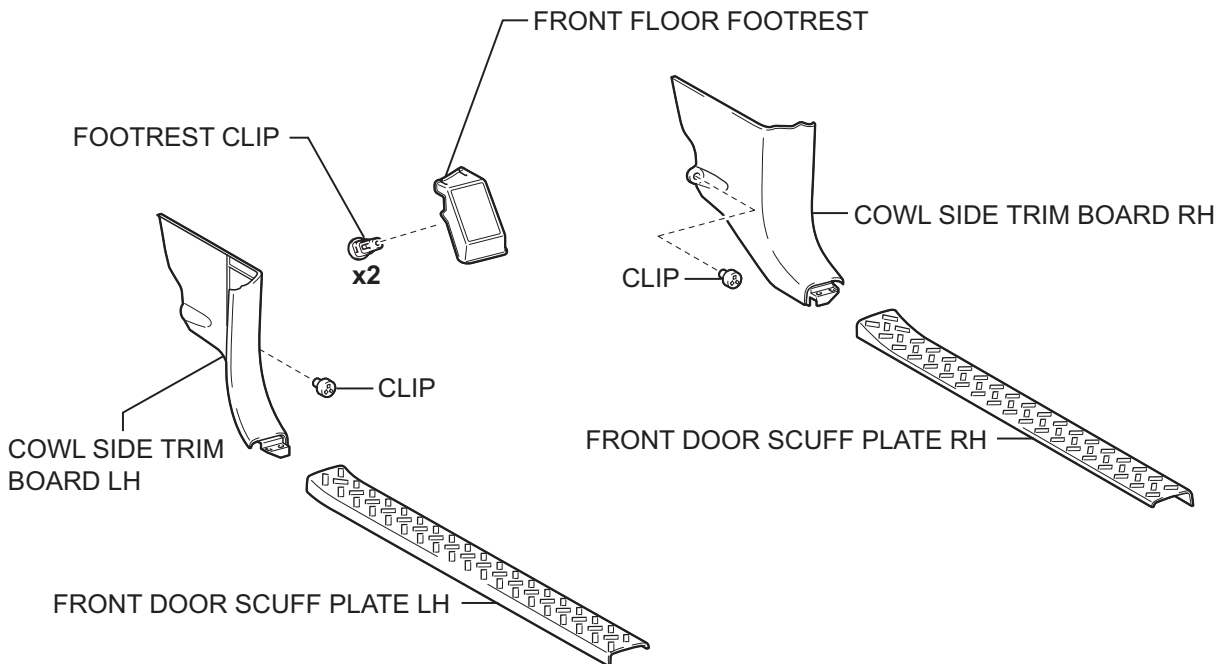
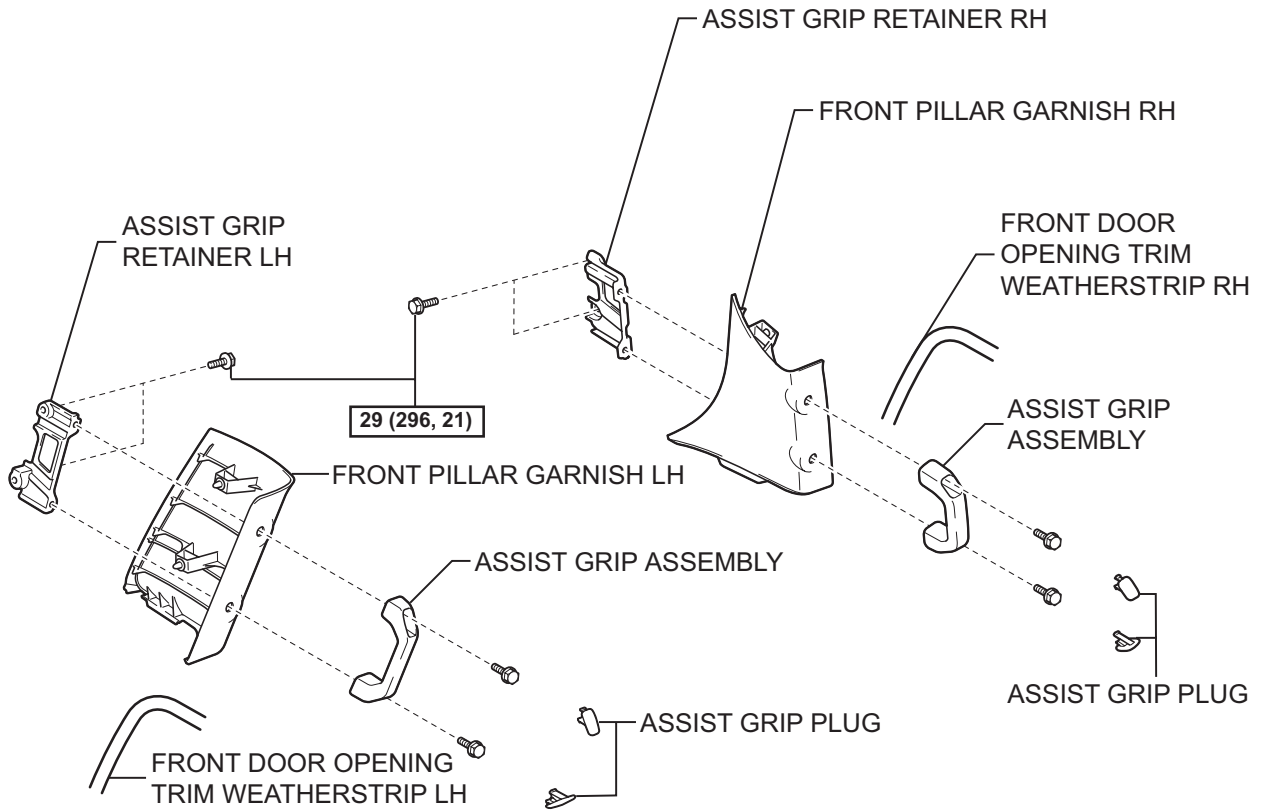

$N^*m$  (kgf\*cm, ft\*lbf) : Specified torque

**for Automatic Transmission 2WD:**

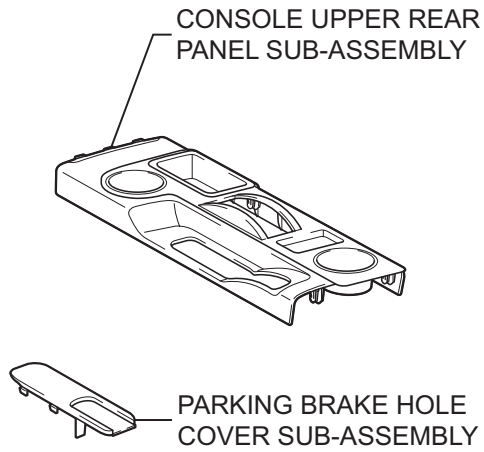

**for Manual Transmission 4WD:**

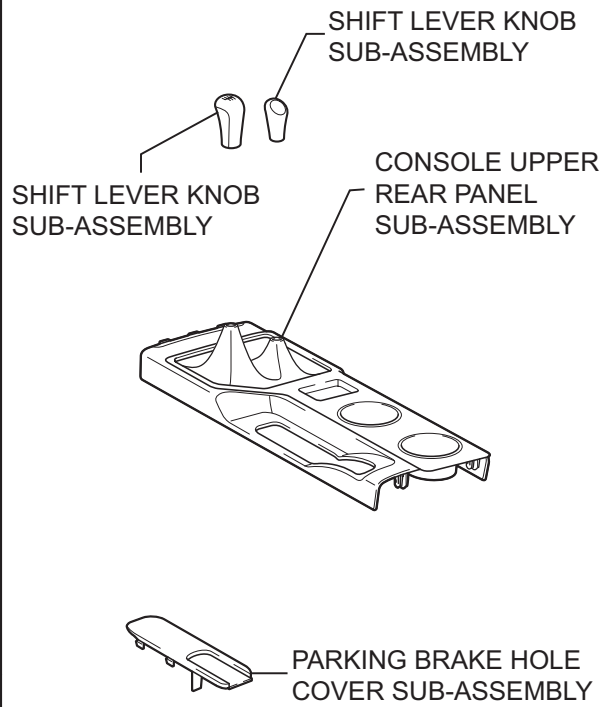

**for Automatic Transmission 4WD:**

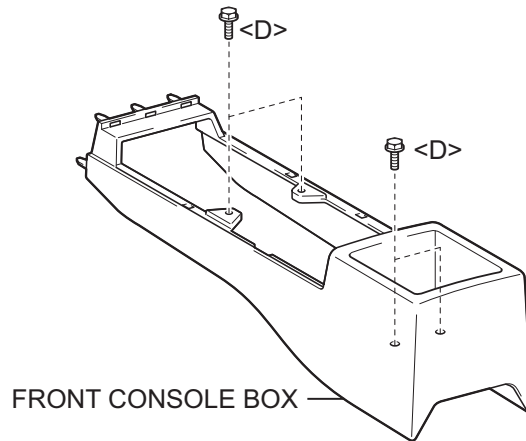
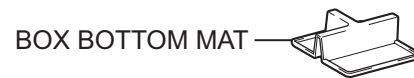
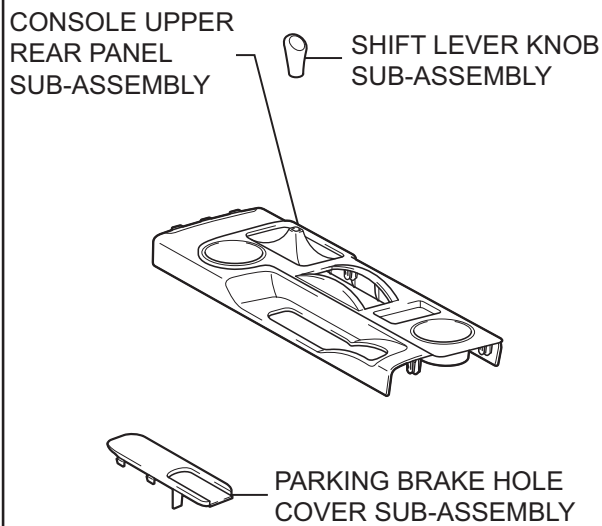

AC

AC

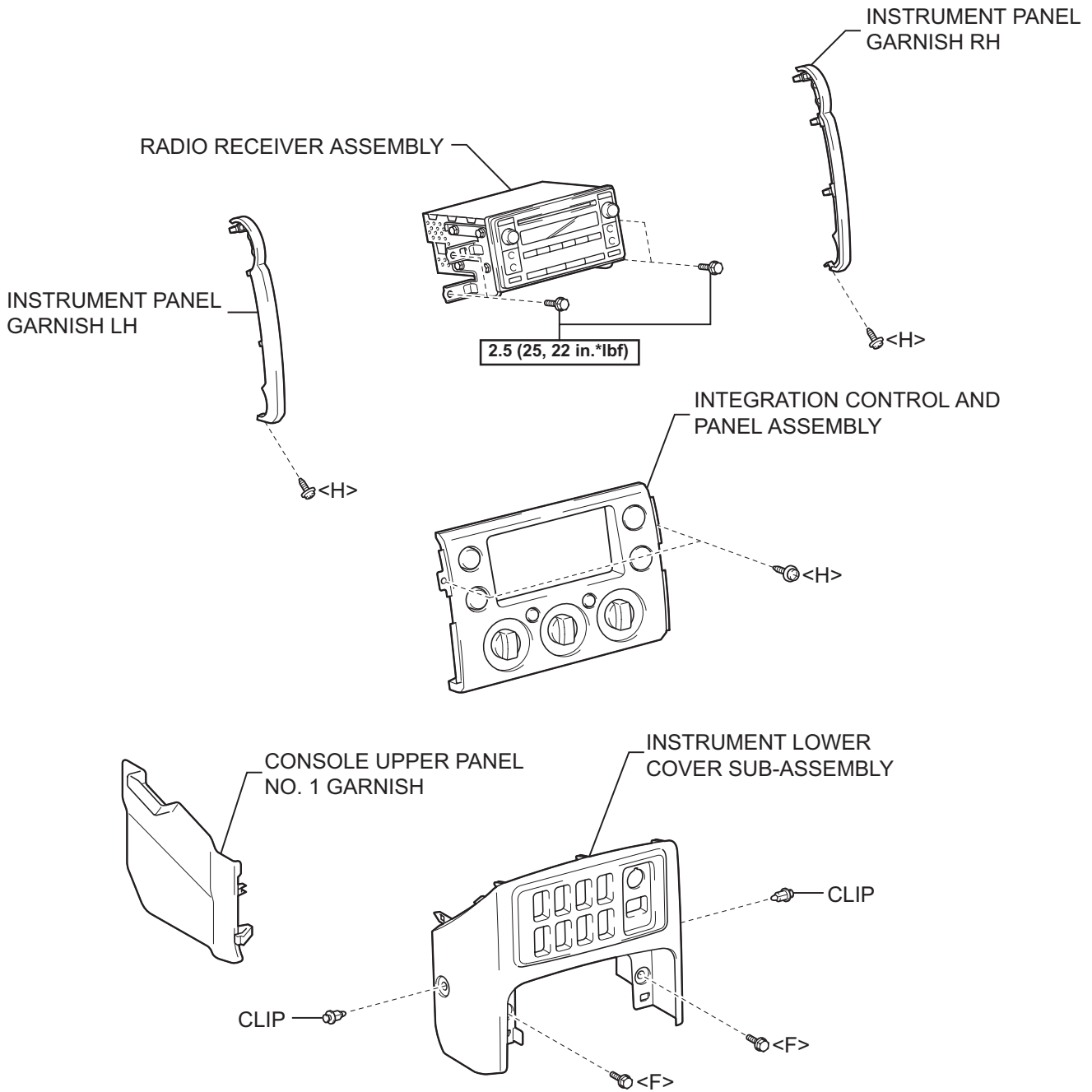

**N\*m (kgf\*cm, ft\*lbf)** : Specified torque

COMBINATION METER ASSEMBLY

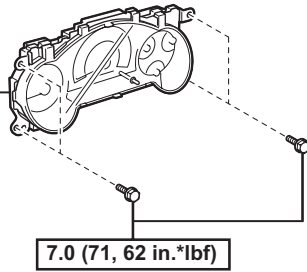

7.0 (71, 62 in.\*lbf)

NO. 2 INSTRUMENT PANEL REGISTER ASSEMBLY

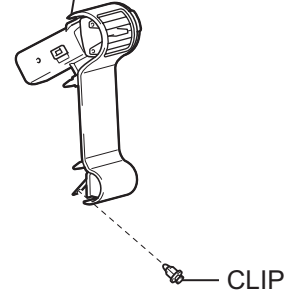

CLIP

NO. 1 INSTRUMENT PANEL REGISTER ASSEMBLY



INSTRUMENT CLUSTER FINISH PANEL

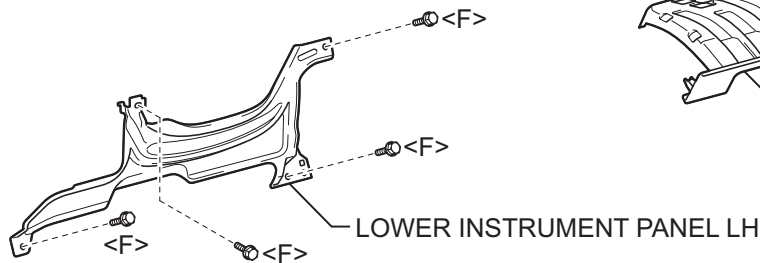

LOWER INSTRUMENT PANEL LH

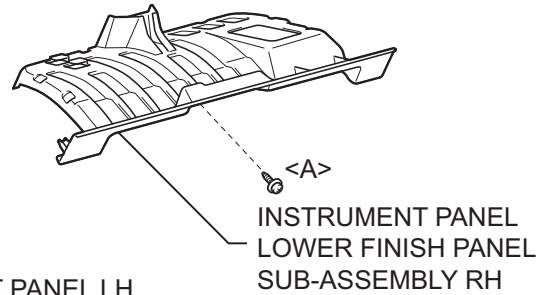

INSTRUMENT PANEL LOWER FINISH PANEL SUB-ASSEMBLY RH

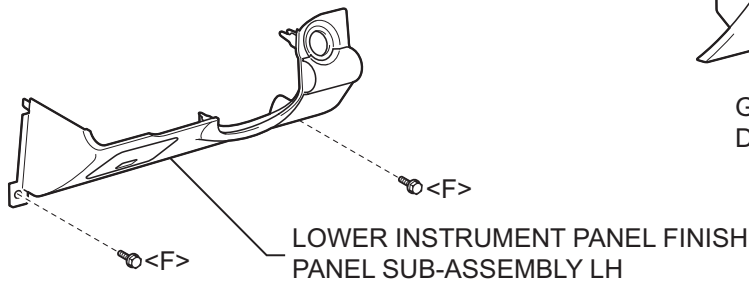

LOWER INSTRUMENT PANEL FINISH PANEL SUB-ASSEMBLY LH

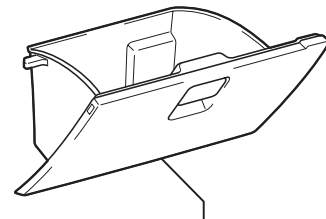

GLOVE COMPARTMENT DOOR ASSEMBLY



HOOD LOCK CONTROL LEVER SUB-ASSEMBLY

**N\*m (kgf\*cm, ft.\*lbf)** : Specified torque

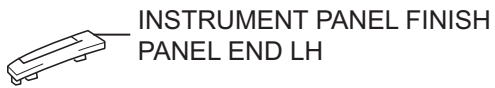

NO. 2 INSTRUMENT PANEL SPEAKER  
PANEL SUB-ASSEMBLY

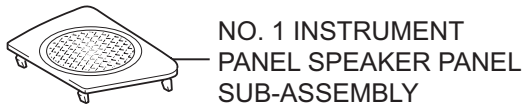
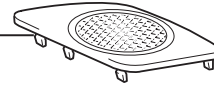

2.5 (25, 22 in.\*lbf)

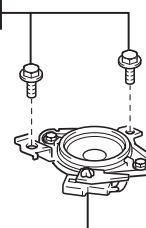

FRONT NO. 2 SPEAKER ASSEMBLY

2.5 (25, 22 in.\*lbf)

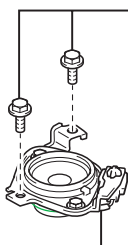

FRONT NO. 2 SPEAKER ASSEMBLY

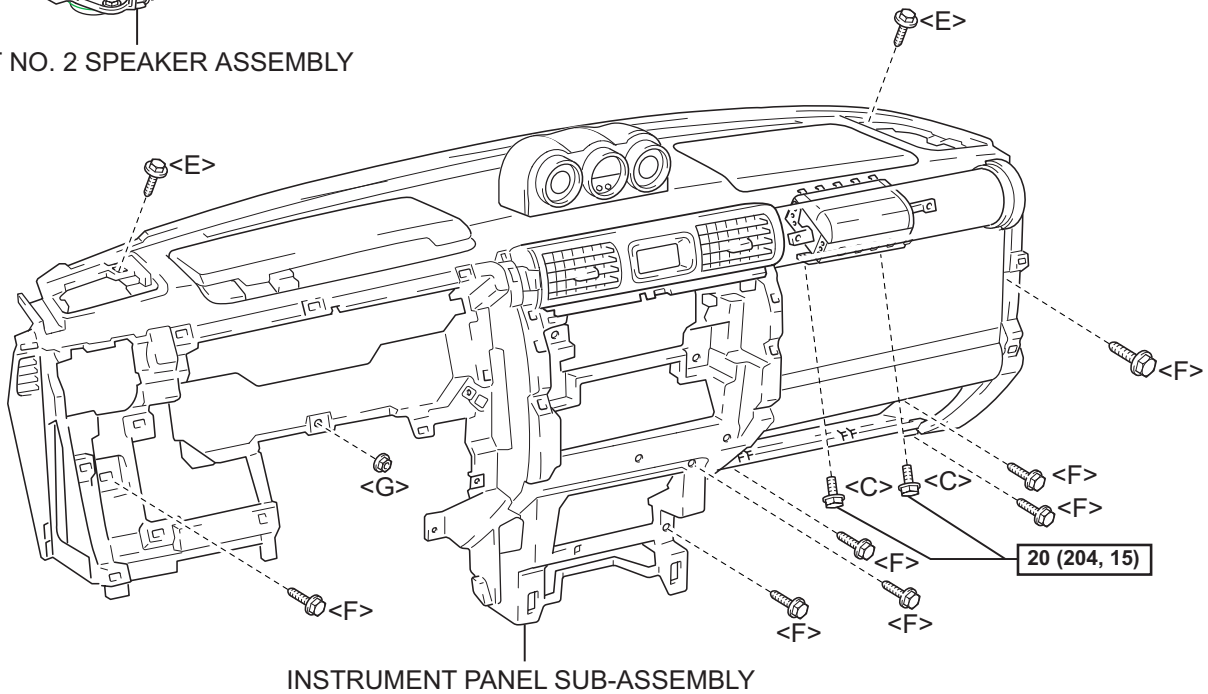

**N\*m (kgf\*cm, ft\*lbf)** : Specified torque

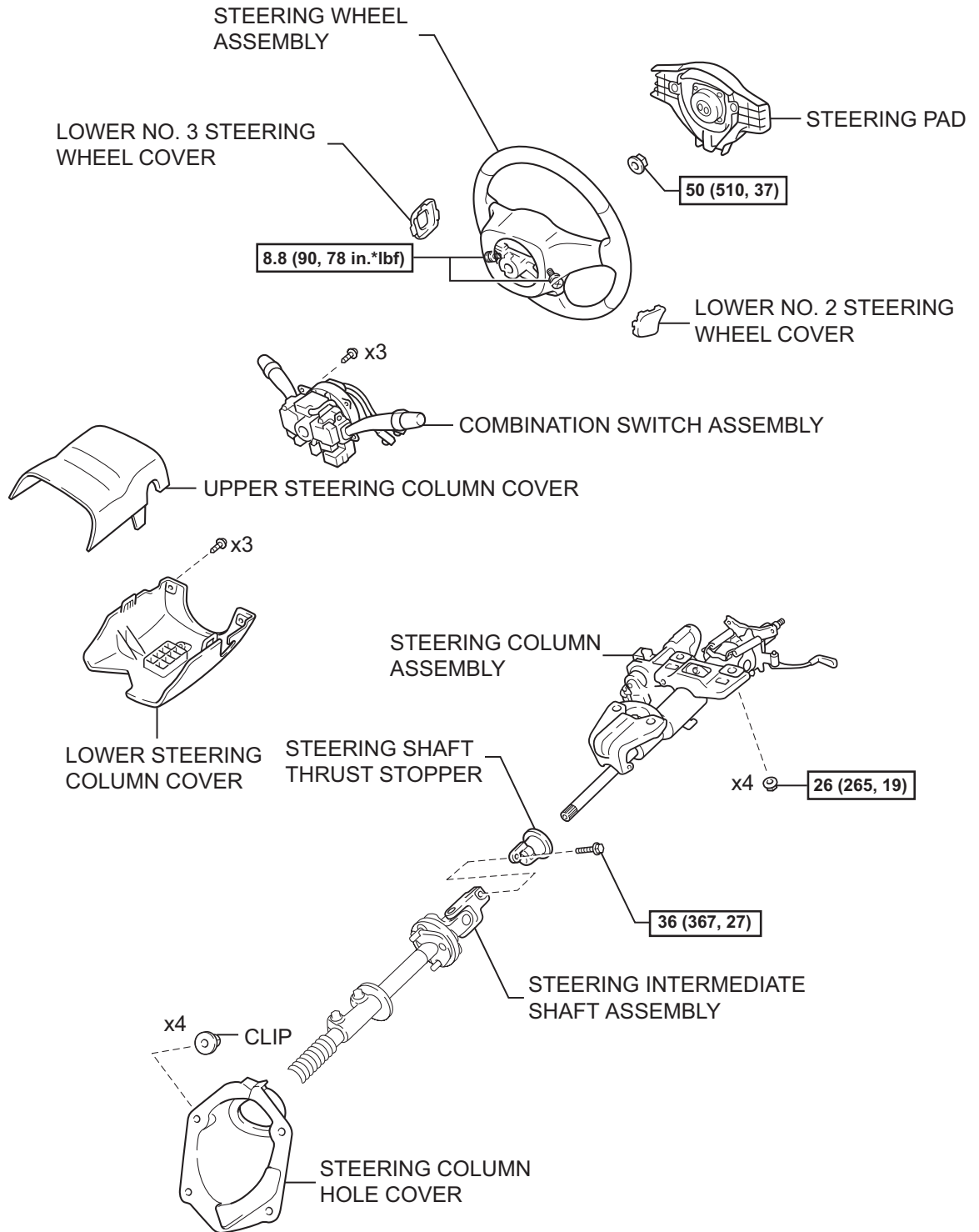

AC

**N\*m (kgf\*cm, ft.\*lbf)** : Specified torque

AC

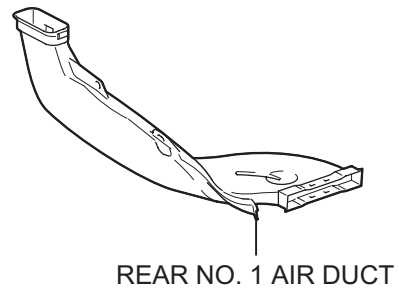
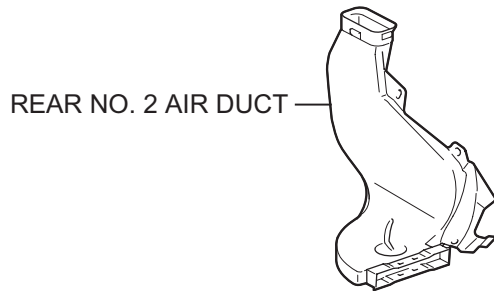
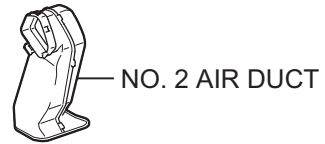
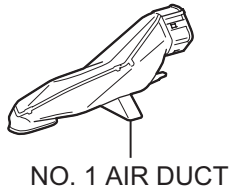
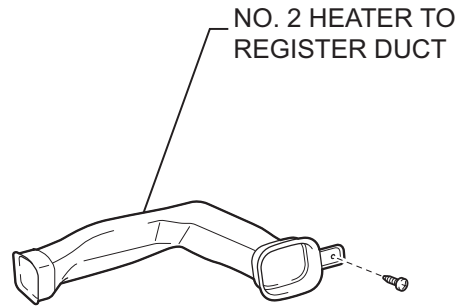
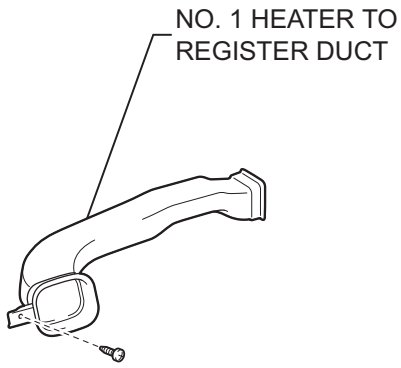



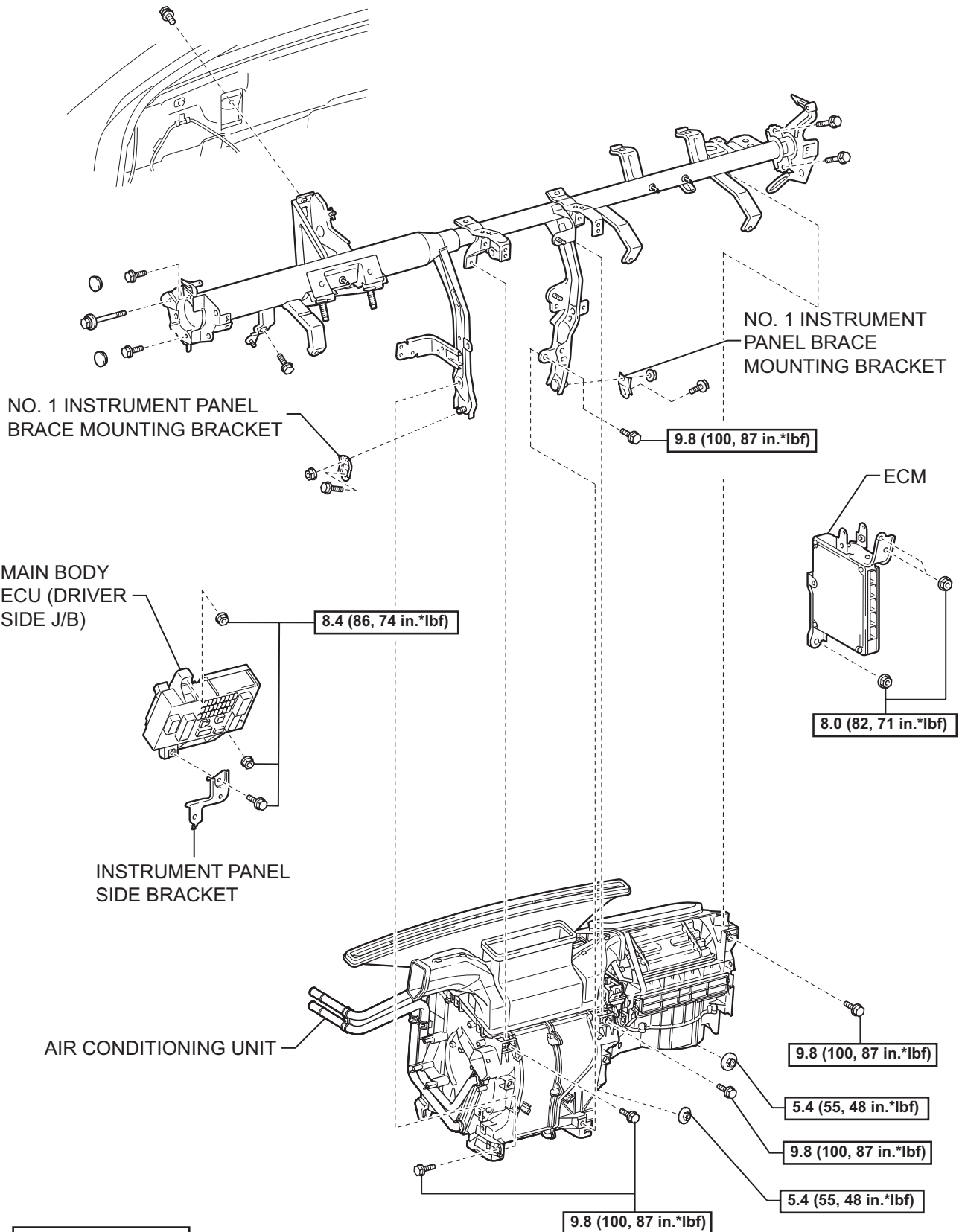

AC

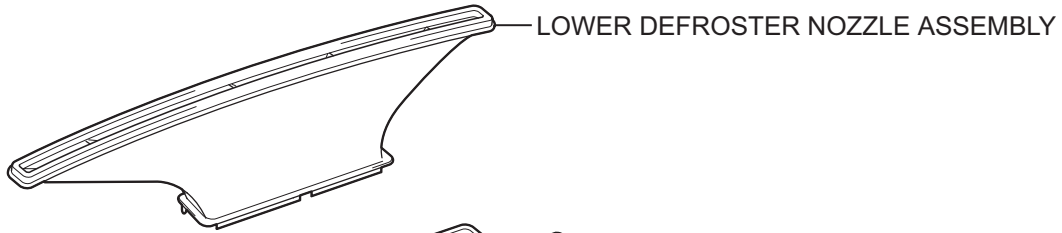

LOWER DEFROSTER NOZZLE ASSEMBLY

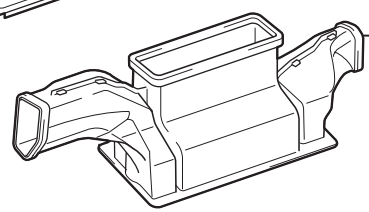

HEATER TO REGISTER DUCT ASSEMBLY

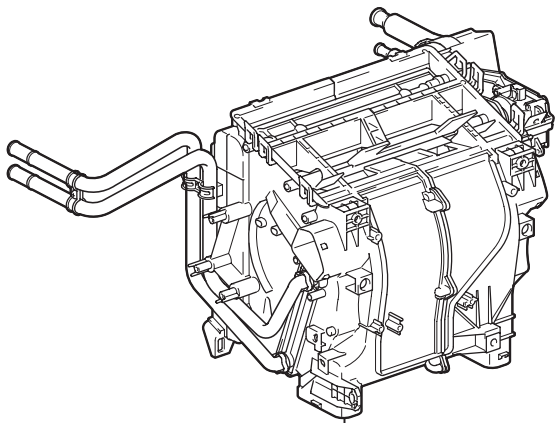

AIR CONDITIONING UNIT ASSEMBLY

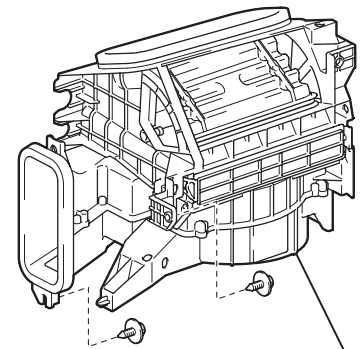

BLOWER UNIT ASSEMBLY

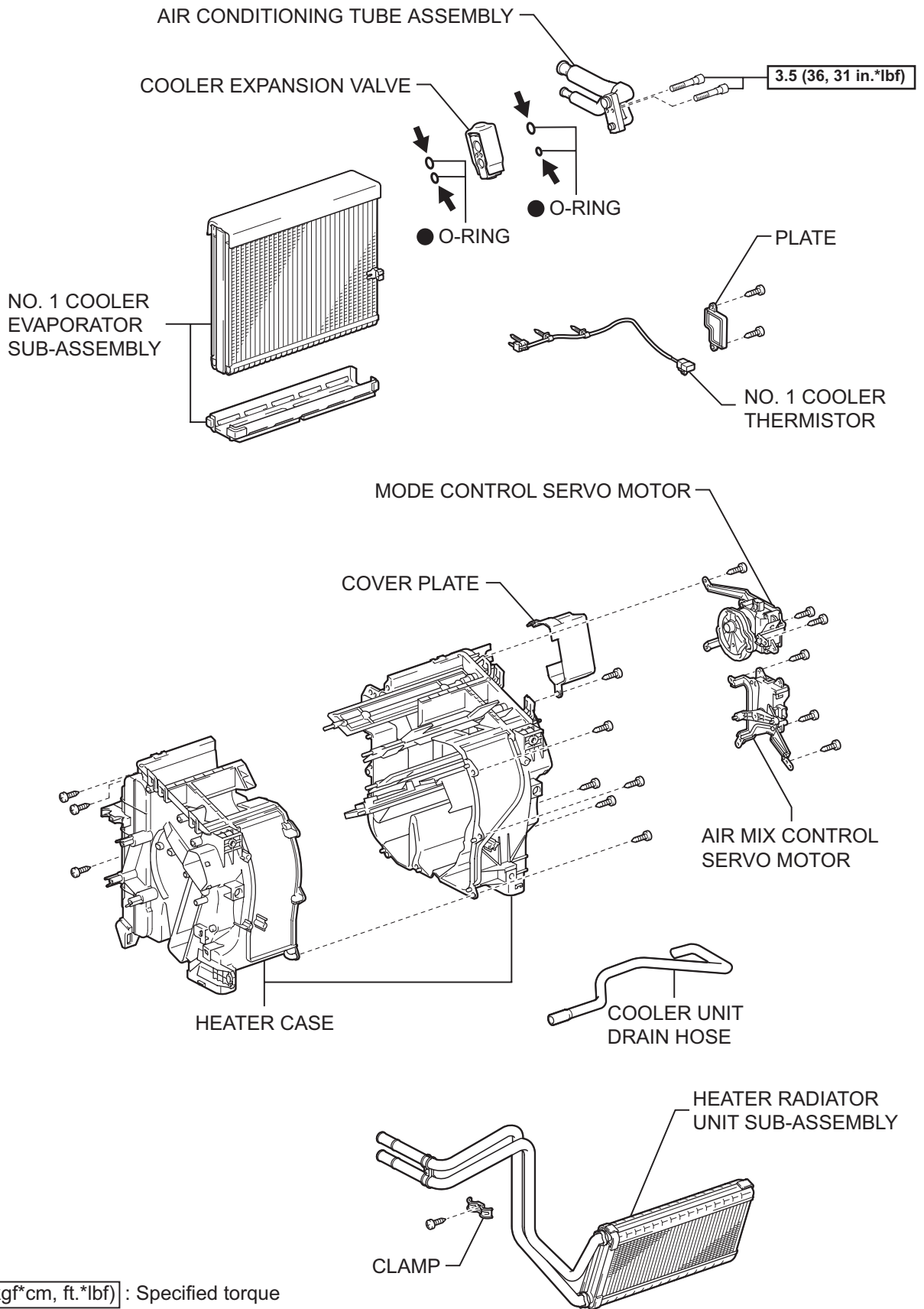

AC

**N\*m (kgf\*cm, ft.\*lbf)** : Specified torque

← Compressor Oil ND-8 or equivalent    ● Non-reusable part