

## REMOVAL

### HINT:

- Use the same procedure for both the RH and LH sides, unless otherwise specified.
- The procedure described below is for the LH side.

1. **DISCONNECT CABLE FROM NEGATIVE BATTERY TERMINAL**
2. **REMOVE REAR SEATBACK BOARD CARPET ASSEMBLY RH (See page [SE-43](#))**
3. **REMOVE REAR SEATBACK ASSEMBLY RH (See page [SE-43](#))**
4. **REMOVE REAR SEATBACK BOARD CARPET ASSEMBLY LH (See page [SE-29](#))**
5. **REMOVE REAR SEATBACK ASSEMBLY LH (See page [SE-29](#))**
6. **REMOVE REAR FLOOR BOARD (See page [IR-13](#))**
7. **REMOVE REAR FLOOR MAT SUPPORT PLATE (See page [IR-14](#))**
8. **REMOVE REAR FLOOR MAT ASSEMBLY (See page [IR-15](#))**
9. **REMOVE LUGGAGE HOLD BELT STRIKER ASSEMBLY (See page [IR-14](#))**
10. **REMOVE FRONT DOOR SCUFF PLATE RH (See page [IR-15](#))**
11. **REMOVE FRONT DOOR SCUFF PLATE LH (See page [IR-15](#))**
12. **REMOVE REAR DOOR SCUFF PLATE RH (See page [IR-15](#))**
13. **REMOVE REAR DOOR SCUFF PLATE LH (See page [IR-15](#))**
14. **REMOVE FRONT DOOR OPENING TRIM WEATHERSTRIP RH (See page [IR-16](#))**
15. **REMOVE FRONT DOOR OPENING TRIM WEATHERSTRIP LH (See page [IR-16](#))**
16. **REMOVE DECK SIDE GARNISH (w/ Woofer) (See page [IR-18](#))**
17. **REMOVE SPEAKER MOUNTING COVER (w/ Woofer) (See page [AV-90](#))**
18. **REMOVE BOX SPEAKER ASSEMBLY (w/ Woofer) (See page [AV-90](#))**
19. **REMOVE PACKAGE HOLDER NET HOOK (See page [IR-18](#))**
20. **REMOVE QUARTER TRIM POCKET TRAY (w/o Woofer) (See page [IR-19](#))**

21. REMOVE SIDE TRIM COVER (w/o Woofer) (See page [IR-19](#))
22. REMOVE QUARTER TRIM POCKET (w/o Woofer) (See page [IR-19](#))
23. REMOVE LAP BELT OUTER ANCHOR COVER (See page [IR-20](#))
24. REMOVE REAR SEAT OUTER BELT ASSEMBLY RH (See page [IR-20](#))
25. REMOVE REAR SEAT OUTER BELT ASSEMBLY LH (See page [IR-20](#))
26. REMOVE REAR DECK TRIM COVER (w/ Power Outlet Socket) (See page [IR-20](#))
27. REMOVE DECK TRIM SIDE PANEL ASSEMBLY RH (See page [IR-21](#))
28. REMOVE DECK TRIM SIDE PANEL ASSEMBLY LH (See page [IR-21](#))
29. REMOVE REAR COMBINATION LIGHT ASSEMBLY
  - (a) Remove the 3 nuts.
  - (b) Disconnect the 3 connectors and remove the rear combination light.

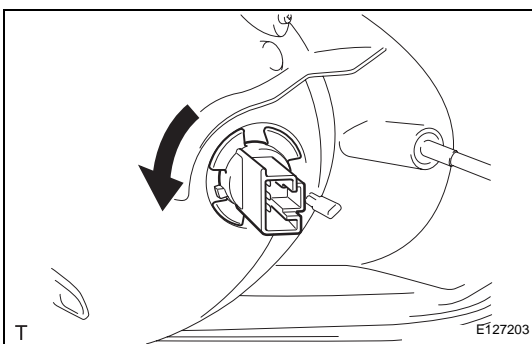
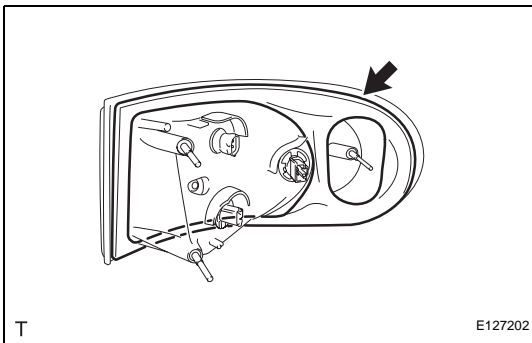
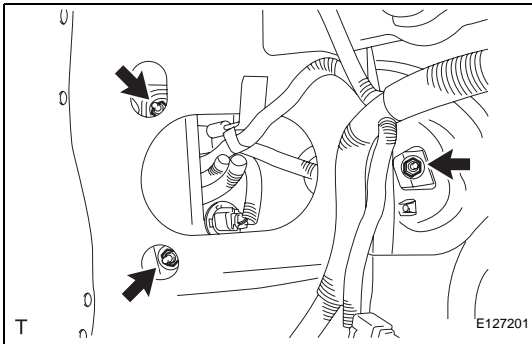

## DISASSEMBLY

1. REMOVE REAR COMBINATION LIGHT GASKET
  - (a) Remove the rear combination light gasket.

**NOTICE:**

  - Detach the gasket if it adheres to the body.
  - Do not reuse a removed gasket. Replace it with a new one to prevent water from entering.
2. REMOVE TAIL AND STOP LIGHT BULB
  - (a) Turn the rear combination light socket and bulb, in the direction indicated by the arrow in the illustration, to remove them.
  - (b) Remove the rear combination light bulb from the light socket.

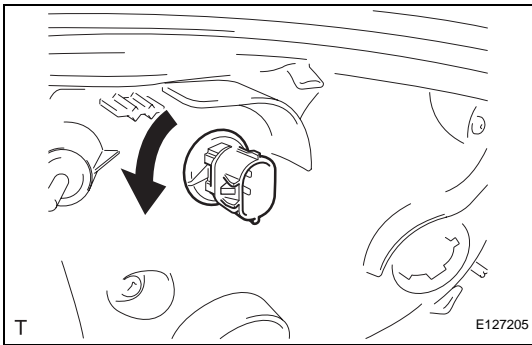

### 3. REMOVE BACK UP LIGHT BULB

- (a) Turn the rear combination light socket and bulb, in the direction indicated by the arrow in the illustration, to remove them.
- (b) Remove the rear combination light bulb from the light socket.

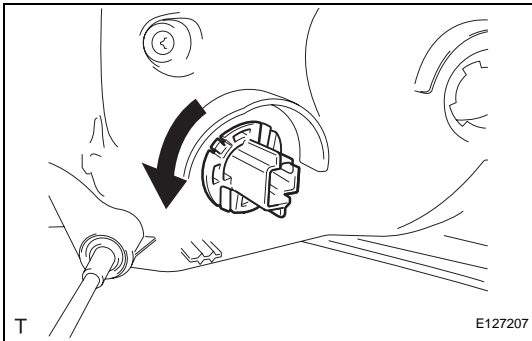

### 4. REMOVE REAR TURN SIGNAL LIGHT BULB

- (a) Turn the rear combination light socket and bulb, in the direction indicated by the arrow in the illustration, to remove them.
- (b) Remove the rear combination light bulb from the light socket.

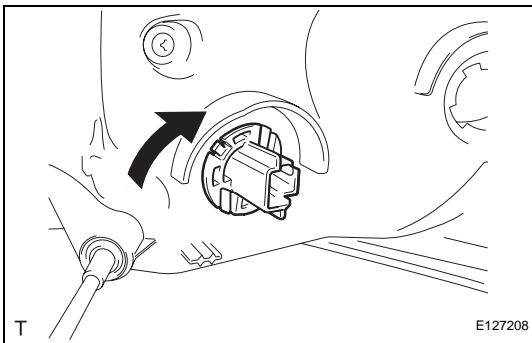

## REASSEMBLY

### 1. INSTALL REAR TURN SIGNAL LIGHT BULB

- (a) Install the rear combination light bulb into the light socket.
- (b) Turn the rear combination light socket and bulb, in the direction indicated by the arrow in the illustration, to install them.

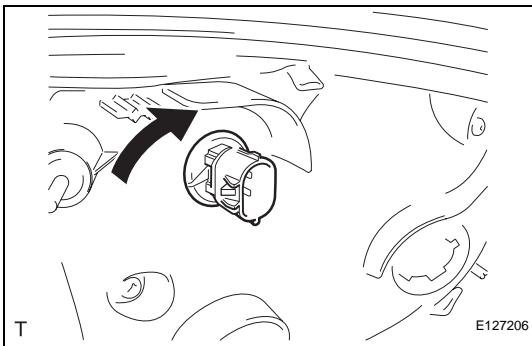

### 2. INSTALL BACK UP LIGHT BULB

- (a) Install the rear combination light bulb into the light socket.
- (b) Turn the rear combination light socket and bulb, in the direction indicated by the arrow in the illustration, to install them.

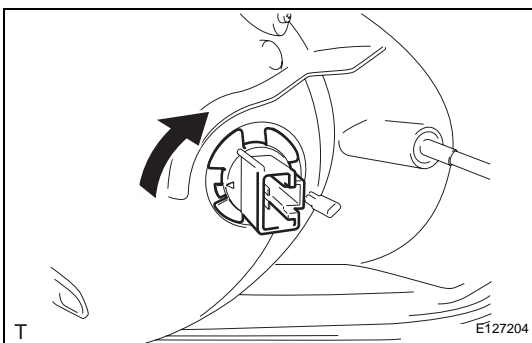

### 3. INSTALL TAIL AND STOP LIGHT BULB

- (a) Install the rear combination light bulb into the light socket.
- (b) Turn the rear combination light socket and bulb, in the direction indicated by the arrow in the illustration, to install them.

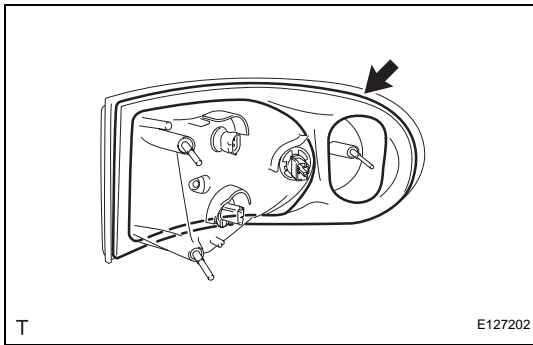

#### 4. INSTALL REAR COMBINATION LIGHT GASKET

- (a) Install a new rear combination light gasket.

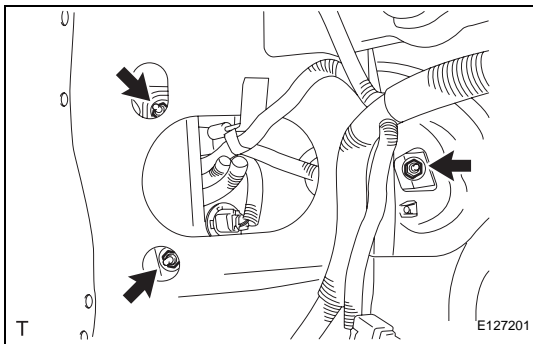

## INSTALLATION

1. **INSTALL REAR COMBINATION LIGHT ASSEMBLY**
  - (a) Connect the 3 connectors and install the rear combination light.
  - (b) Install the 3 nuts.  
Torque: 6.0 N\*m (61 kgf\*cm, 53 in.\*lbf)
2. **INSTALL DECK TRIM SIDE PANEL ASSEMBLY RH** (See page [IR-39](#))
3. **INSTALL DECK TRIM SIDE PANEL ASSEMBLY LH** (See page [IR-39](#))
4. **INSTALL REAR DECK TRIM COVER (w/ Power Outlet Socket)** (See page [IR-40](#))
5. **INSTALL REAR SEAT OUTER BELT ASSEMBLY RH** (See page [IR-40](#))
6. **INSTALL REAR SEAT OUTER BELT ASSEMBLY LH** (See page [IR-40](#))
7. **INSTALL LAP BELT OUTER ANCHOR COVER** (See page [IR-41](#))
8. **INSTALL BOX SPEAKER ASSEMBLY (w/ Woofer)** (See page [AV-90](#))
9. **INSTALL SPEAKER MOUNTING COVER (w/ Woofer)** (See page [AV-91](#))
10. **INSTALL DECK SIDE GARNISH (w/ Woofer)** (See page [IR-41](#))
11. **INSTALL QUARTER TRIM POCKET (w/o Woofer)** (See page [IR-41](#))
12. **INSTALL SIDE TRIM COVER (w/o Woofer)** (See page [IR-42](#))
13. **INSTALL QUARTER TRIM POCKET TRAY (w/o Woofer)** (See page [IR-42](#))
14. **INSTALL PACKAGE HOLDER NET HOOK** (See page [IR-42](#))
15. **INSTALL FRONT DOOR OPENING TRIM WEATHERSTRIP RH** (See page [IR-44](#))
16. **INSTALL FRONT DOOR OPENING TRIM WEATHERSTRIP LH** (See page [IR-44](#))

17. INSTALL REAR DOOR SCUFF PLATE RH (See page [IR-45](#))
18. INSTALL REAR DOOR SCUFF PLATE LH (See page [IR-45](#))
19. INSTALL FRONT DOOR SCUFF PLATE RH (See page [IR-45](#))
20. INSTALL FRONT DOOR SCUFF PLATE LH (See page [IR-45](#))
21. INSTALL LUGGAGE HOLD BELT STRIKER ASSEMBLY (See page [IR-46](#))
22. INSTALL REAR FLOOR MAT ASSEMBLY (See page [IR-46](#))
23. INSTALL REAR FLOOR MAT SUPPORT PLATE (See page [IR-46](#))
24. INSTALL REAR FLOOR BOARD (See page [IR-47](#))
25. INSTALL REAR SEATBACK ASSEMBLY RH (See page [SE-54](#))
26. INSTALL REAR SEATBACK BOARD CARPET ASSEMBLY RH (See page [SE-54](#))
27. INSTALL REAR SEATBACK ASSEMBLY LH (See page [SE-38](#))
28. INSTALL REAR SEATBACK BOARD CARPET ASSEMBLY LH (See page [SE-38](#))
29. CONNECT CABLE TO NEGATIVE BATTERY TERMINAL  
Torque: 3.9 N\*m (40 kgf\*cm, 35 in.\*lbf)

