

REAR DOOR COURTESY SWITCH (for Upper Side)

COMPONENTS

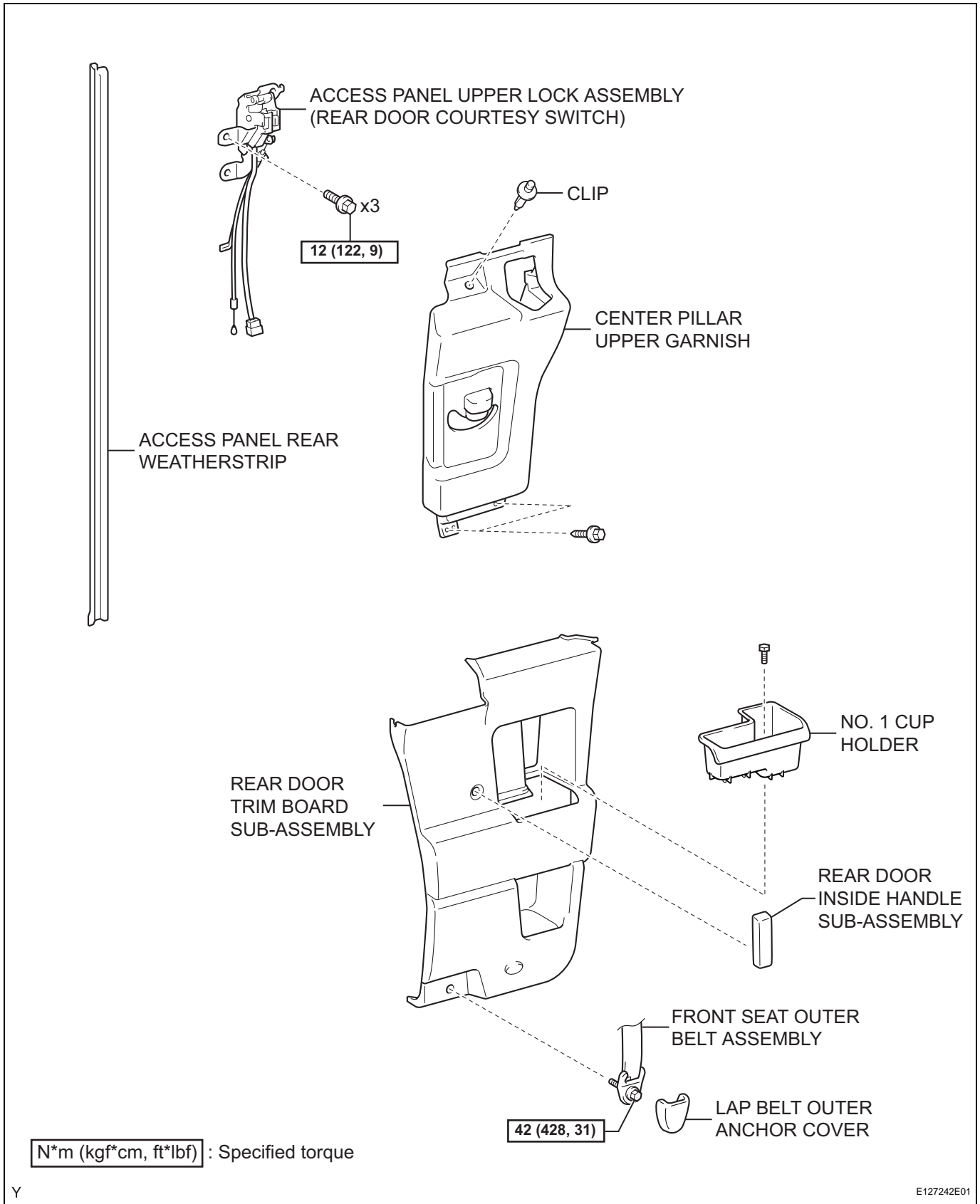

N*m (kgf*cm, ft*lbf) : Specified torque

REMOVAL

HINT:

- Use the same procedure for both the RH and LH sides.
- The procedure described below is for the LH side.

1. **DISCONNECT CABLE FROM NEGATIVE BATTERY TERMINAL**
2. **REMOVE ACCESS PANEL REAR WEATHERSTRIP** (See page [ED-29](#))
3. **REMOVE LAP BELT OUTER ANCHOR COVER** (See page [ED-29](#))
4. **REMOVE REAR DOOR INSIDE HANDLE SUB-ASSEMBLY** (See page [ED-29](#))
5. **REMOVE NO. 1 CUP HOLDER** (See page [ED-29](#))
6. **REMOVE REAR DOOR TRIM BOARD SUB-ASSEMBLY** (See page [ED-30](#))
7. **REMOVE CENTER PILLAR UPPER GARNISH** (See page [ED-30](#))
8. **REMOVE ACCESS PANEL UPPER LOCK ASSEMBLY**
 - (a) Disconnect the connector, harness clamp and the access panel lock control cable.

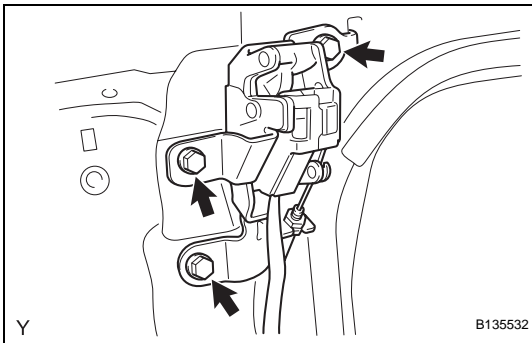
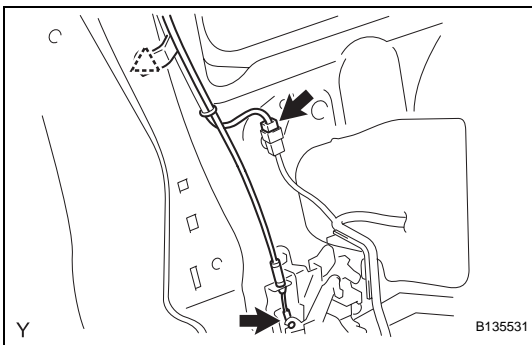

- (b) Remove the 3 bolts, then remove the access panel upper lock.