

FRONT PROPELLER SHAFT ASSEMBLY (for 4WD)

COMPONENTS

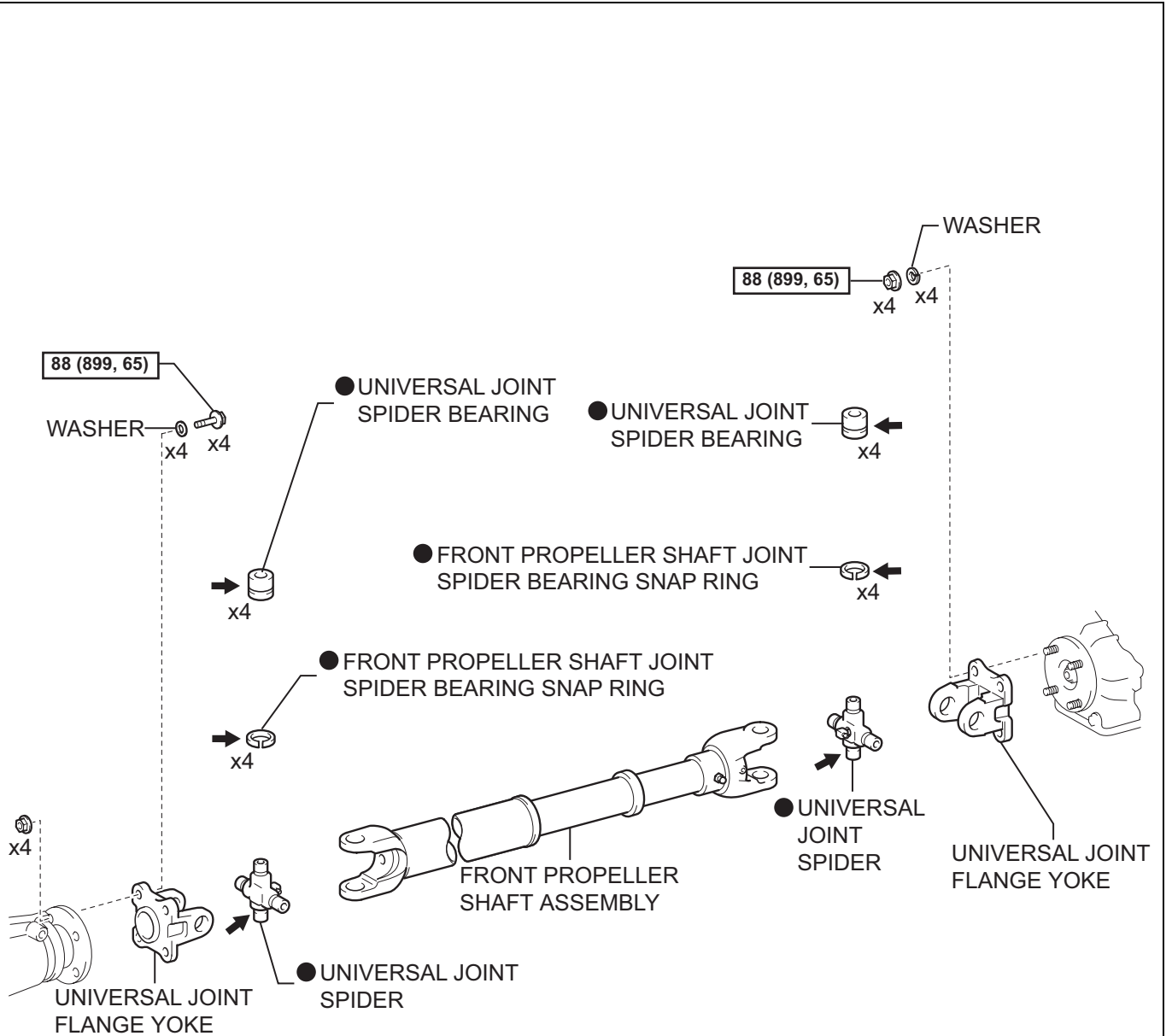

88 (899, 65) : Specified torque

● Non-reusable part

← MP grease

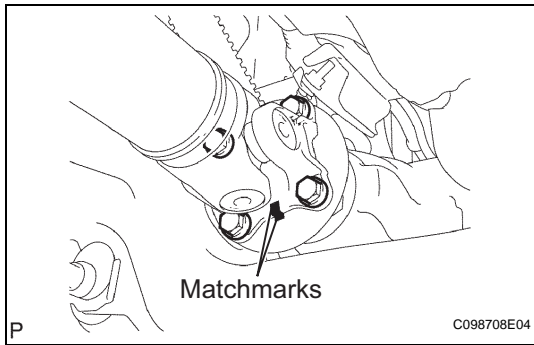

REMOVAL

1. **REMOVE FRONT PROPELLER SHAFT ASSEMBLY**
 - (a) Place matchmarks on the propeller shaft flange and differential flange.
 - (b) Remove the 4 nuts, 4bolts and 4 washers.

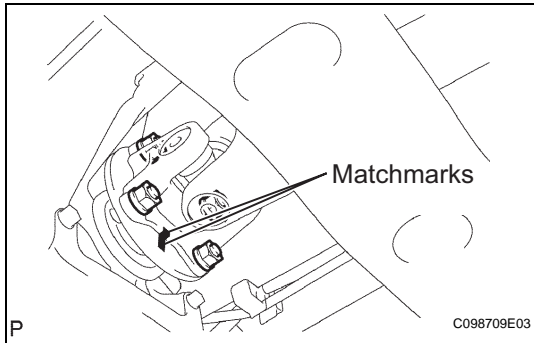

- (c) Place matchmarks on the propeller shaft flange and transfer flange.
 - (d) Remove the 4 nuts, 4 washers and the propeller shaft assembly.