

REAR PROPELLER SHAFT ASSEMBLY

COMPONENTS

for 2WD:

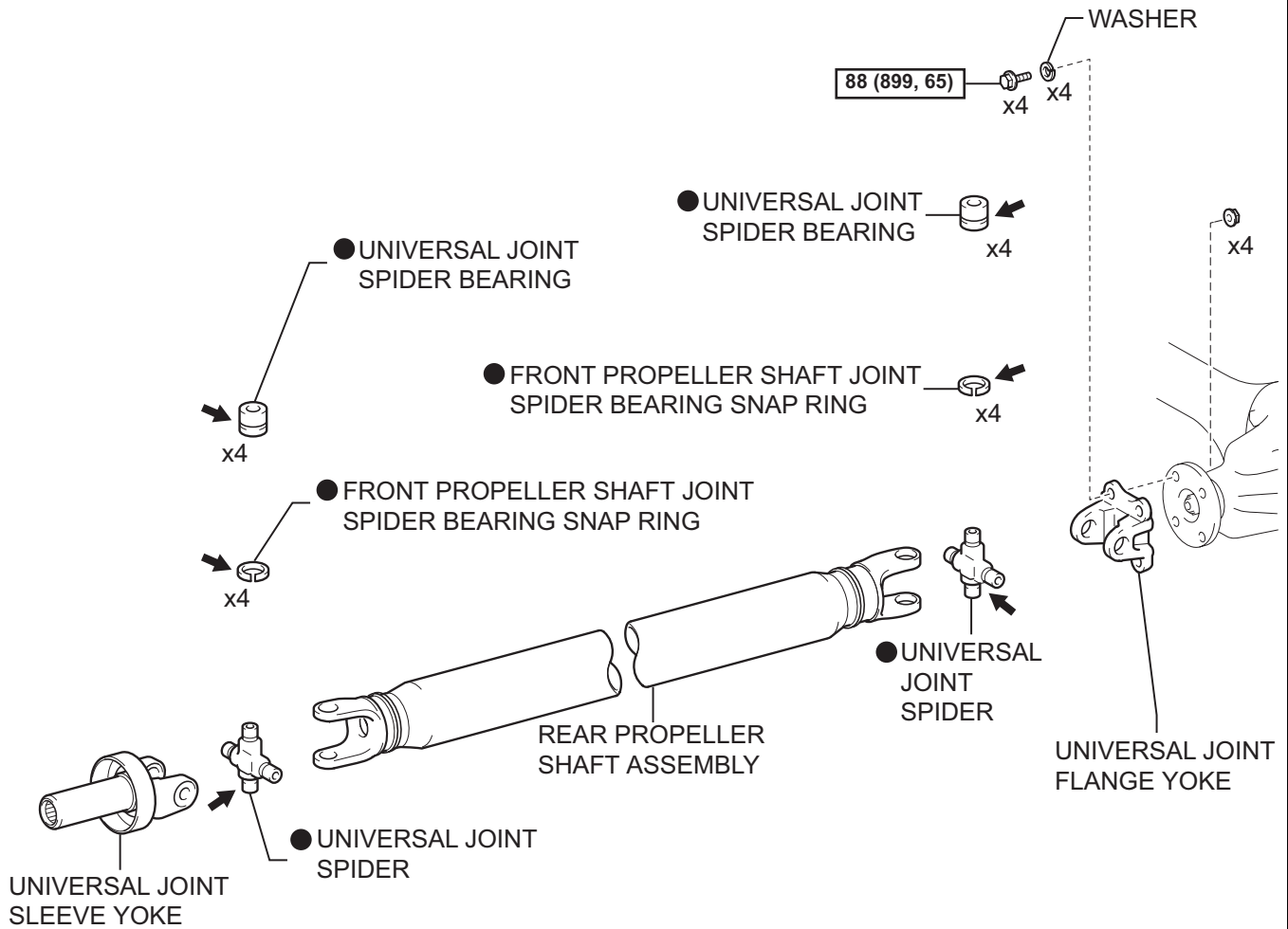

$N \cdot m$ (kgf \cdot cm, ft \cdot lbf) : Specified torque

● Non-reusable part

← MP grease

PR

for 4WD:

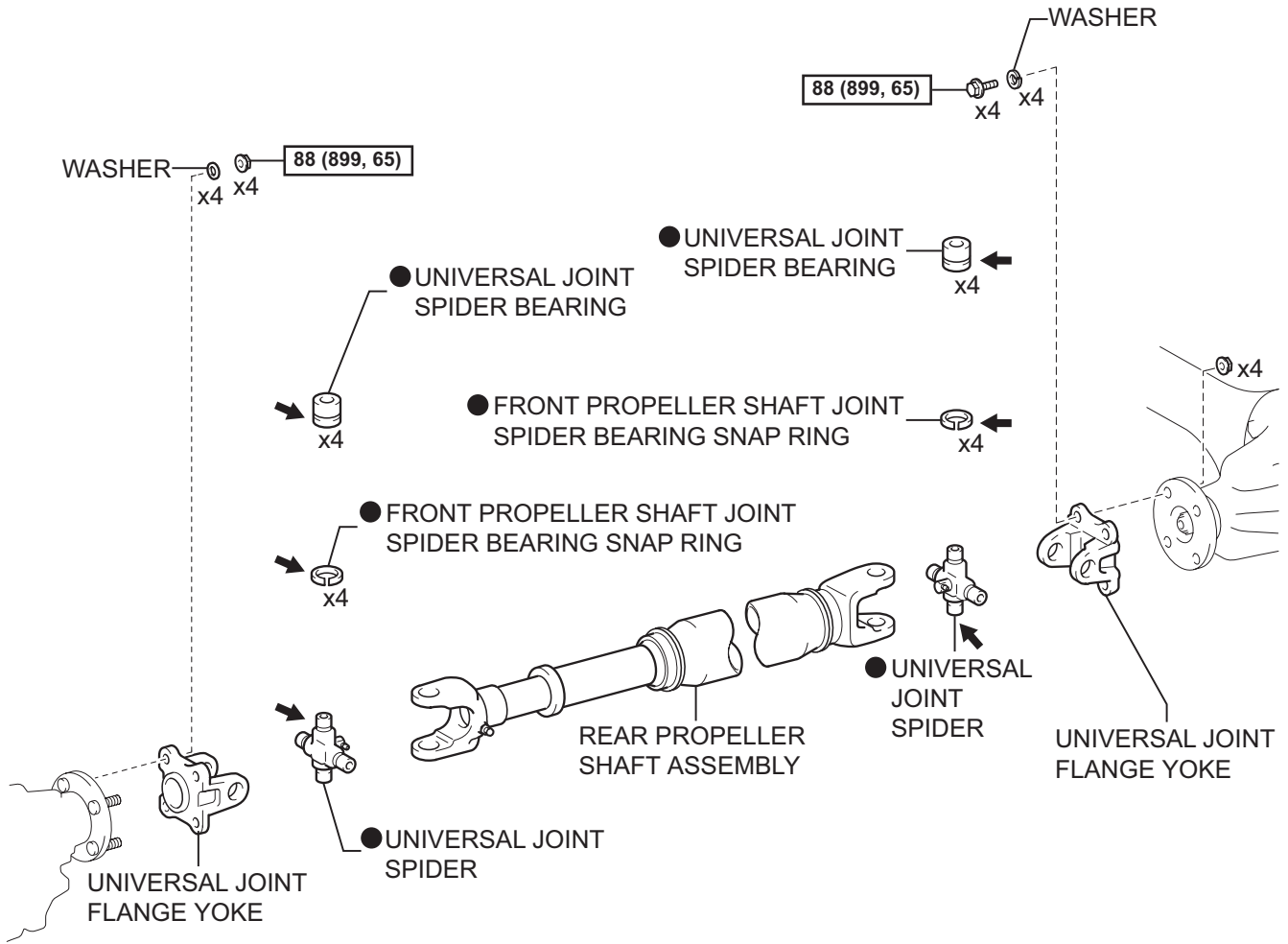

PR

$N \cdot m$ ($kgf \cdot cm$, $ft \cdot lbf$): Specified torque

● Non-reusable part

← MP grease

REMOVAL

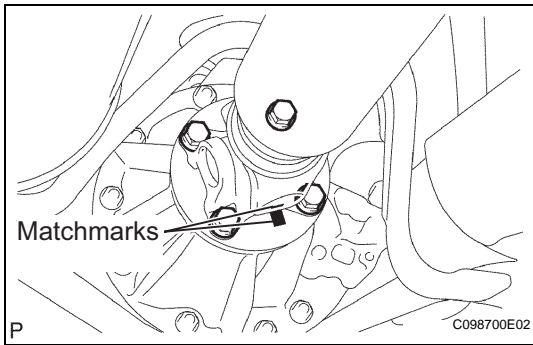

1. REMOVE REAR PROPELLER SHAFT ASSEMBLY (for 2WD)

- (a) Place matchmarks on the propeller shaft flange and differential flange.
- (b) Remove the 4 nuts, 4 bolts and 4 washers.
- (c) Remove the propeller shaft assembly.

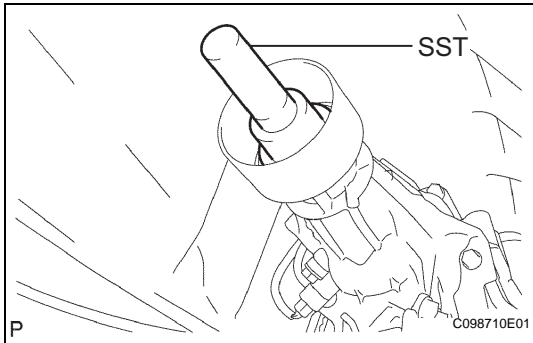

- (d) Insert SST into the extension housing to prevent oil leakage.

SST 09325-40010

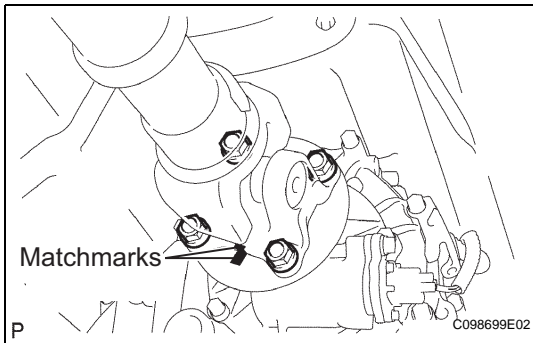

2. REMOVE REAR PROPELLER SHAFT ASSEMBLY (for 4WD)

- (a) Place matchmarks on the propeller shaft flange and transfer flange.
- (b) Remove the 4 nuts and 4 washers.

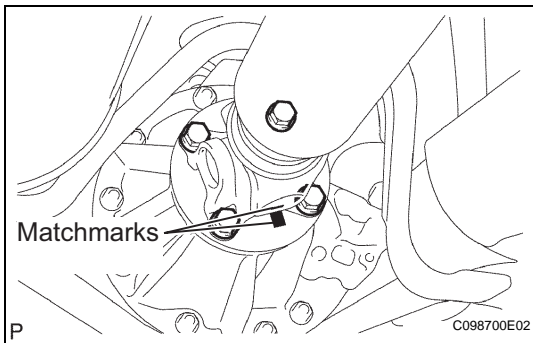

- (c) Place matchmarks on the propeller shaft flange and differential flange.
- (d) Remove the 4 nuts, 4 bolts, 4 washers and the propeller shaft assembly.