

REMOVAL

1. DISCONNECT CABLE FROM NEGATIVE BATTERY TERMINAL
2. REMOVE PARKING BRAKE HOLE COVER SUB-ASSEMBLY (See page IP-11)
3. REMOVE CONSOLE UPPER REAR PANEL SUB-ASSEMBLY (See page IP-12)
4. REMOVE FRONT CONSOLE BOX (See page IP-12)
5. REMOVE SHIFT LEVER KNOB SUB-ASSEMBLY (for Transfer)
6. REMOVE SHIFT LEVER KNOB SUB-ASSEMBLY (for Manual Transmission)
7. REMOVE SHIFT LEVER BOOT ASSEMBLY
 - (a) Remove the 4 screws and 2 clips, then remove the shift lever boot.

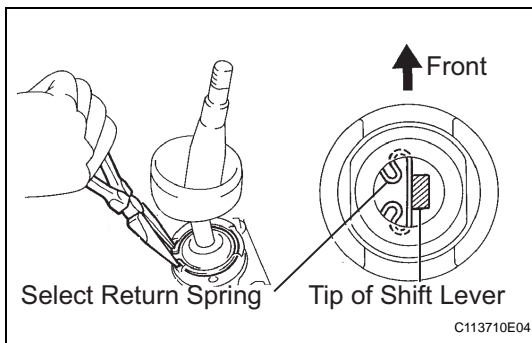

8. REMOVE TRANSFER HIGH AND LOW SHIFT LEVER ASSEMBLY
 - (a) Using needle-nose pliers, remove the snap ring and pull out the shift lever from the shift lever retainer.

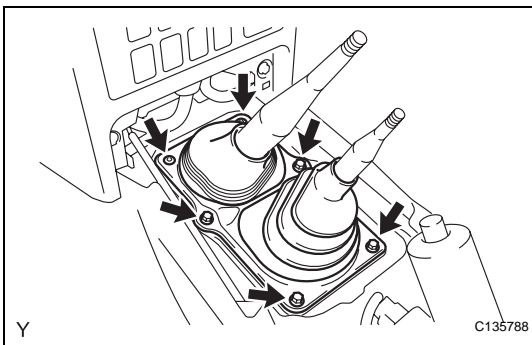
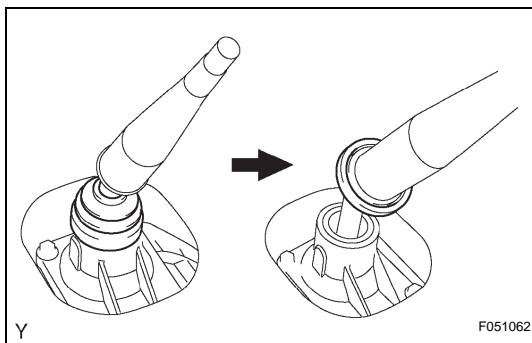

9. REMOVE FLOOR SHIFT LEVER ASSEMBLY
 - (a) Separate the shift lever cap boot from the manual transmission.

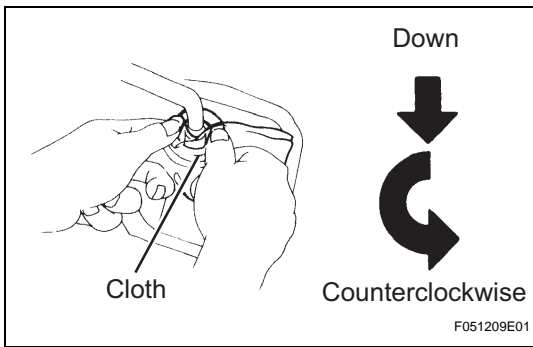

- (b) Cover the shift lever cap with a cloth.
- (c) Pressing down on the shift lever cap, turn it counterclockwise to remove the shift lever.
- (d) Pull out the shift lever.

10. DRAIN MANUAL TRANSMISSION OIL

- (a) Remove the drain plug and gasket and then drain the manual transmission oil.
- (b) Install a new gasket and drain plug.
Torque: 37 N*m (377 kgf*cm, 27 ft.*lbf)

11. REMOVE NO. 2 FRONT EXHAUST PIPE ASSEMBLY (See page EX-4)

12. REMOVE FRONT EXHAUST PIPE ASSEMBLY (See page EX-4)

13. REMOVE PROPELLER SHAFT HEAT INSULATOR

- (a) Remove the 2 bolts and remove the propeller shaft heat insulator.

14. REMOVE FRONT PROPELLER SHAFT ASSEMBLY (See page PR-2)

15. REMOVE PROPELLER SHAFT ASSEMBLY (See page PR-9)

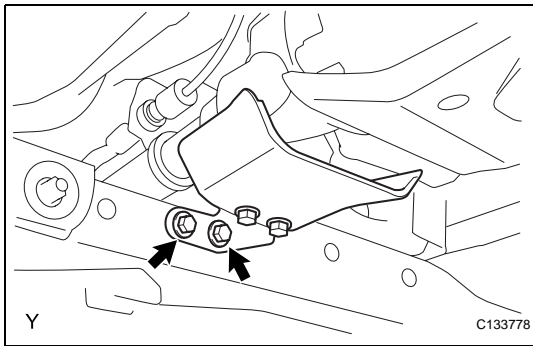

16. REMOVE NO. 2 MANIFOLD STAY

- (a) Remove the 3 bolts and remove the No. 2 manifold stay.

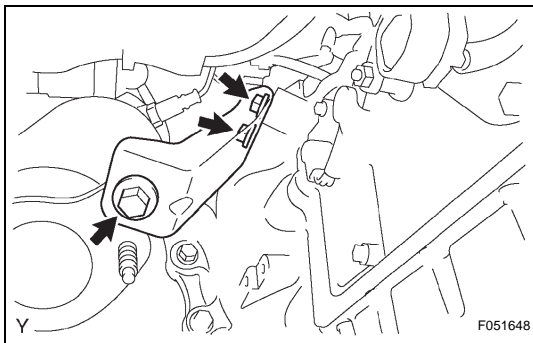

17. REMOVE MANIFOLD STAY

- (a) Remove the 3 bolts and remove the manifold stay.

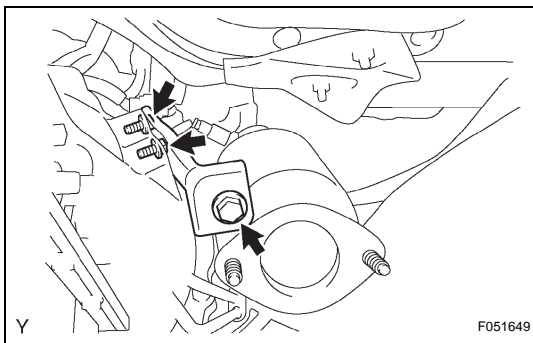

18. REMOVE STARTER ASSEMBLY (See page ST-7)

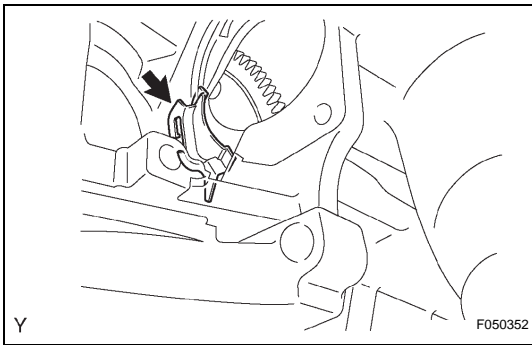

- 19. REMOVE FLYWHEEL HOUSING SIDE COVER**
 (a) Remove the flywheel housing side cover from the cylinder block.

- 20. REMOVE NO. 1 CLUTCH HOUSING COVER (See page CL-16)**

- 21. REMOVE CLUTCH RELEASE CYLINDER ASSEMBLY (See page CL-16)**

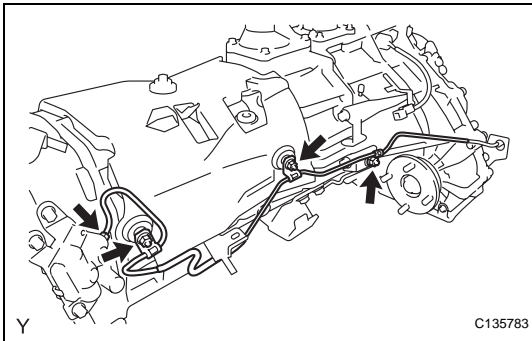

- 22. REMOVE ACCUMULATOR TO FLEXIBLE HOSE TUBE**

- (a) Using SST, disconnect the hose tube. (for accumulator side)
SST 09023-00101
 (b) Remove the 3 nuts and disconnect the hose tube.

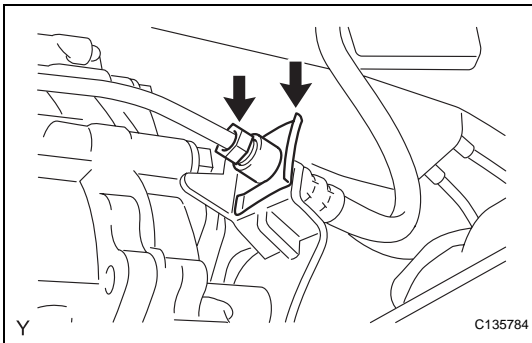

- (c) Using SST, disconnect the hose tube. (for flexible hose side)
SST 09023-00101
 (d) Remove the clip

- 23. REMOVE CLUTCH ACCUMULATOR ASSEMBLY (See page CL-19)**

- 24. SUPPORT MANUAL TRANSMISSION WITH TRANSFER**

- (a) Support the manual transmission with a transmission jack.

- 25. REMOVE FRONT SUSPENSION MEMBER BRACKET LH**

- (a) Remove the 4 bolts and remove the front suspension member bracket LH.

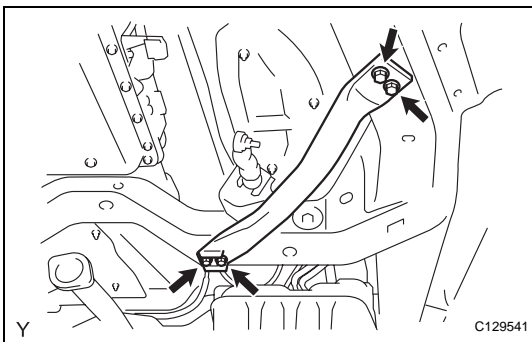

- 26. REMOVE FRONT SUSPENSION MEMBER BRACKET**

- (a) Remove the 4 bolts and remove the front suspension member bracket RH.

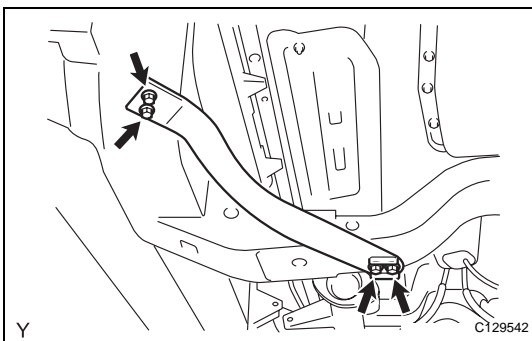

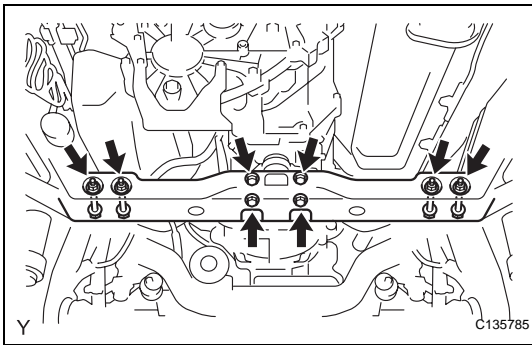

27. REMOVE NO. 3 FRAME CROSSMEMBER SUB-ASSEMBLY

- (a) Remove the 4 bolts from the No. 3 frame crossmember sub-assembly.
- (b) Remove the 4 nuts and 4 bolts and remove the No. 3 frame crossmember sub-assembly.

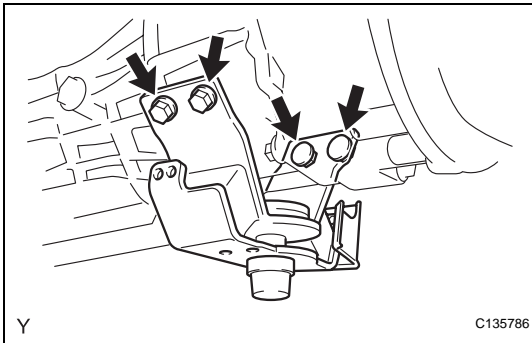

28. REMOVE REAR NO. 1 ENGINE MOUNTING INSULATOR

- (a) Remove the 4 bolts and engine mounting insulator rear from the manual transmission.

29. DISCONNECT CONNECTOR

- (a) Tilt down the transmission.
- (b) Disconnect the 2 transfer indicator switch connectors.
- (c) Disconnect the speedometer sensor connector.
- (d) Disconnect the back-up light switch connector.

30. DISCONNECT WIRE HARNESS

31. REMOVE MANUAL TRANSMISSION WITH TRANSFER

- (a) Remove the 9 bolts.
- (b) Separate and remove the manual transmission.

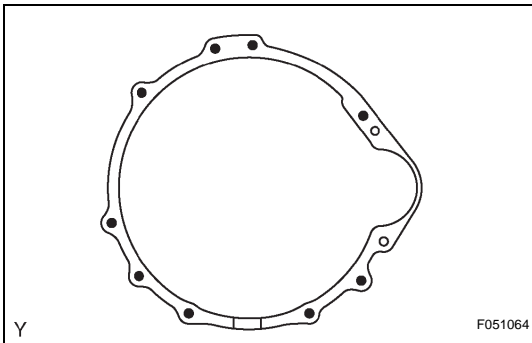

32. REMOVE MANUAL TRANSMISSION CASE COVER SUB-ASSEMBLY

- (a) Remove the 3 bolts and 2 nuts and remove the manual transmission case cover.

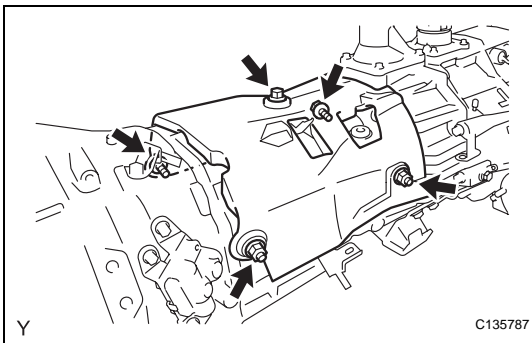

33. REMOVE TRANSFER ASSEMBLY (See page [TF-18](#))