

REMOVAL

HINT:

The procedure described below is for the RH side. Use the same procedure for both the RH and LH sides, unless otherwise specified.

1. **REMOVE CABLE FROM NEGATIVE BATTERY TERMINAL**
2. **REMOVE REAR SEATBACK BOARD CARPET ASSEMBLY**
 - (a) for RH Side:
 - (1) Remove the rear seatback board carpet assembly (See page [SE-43](#)).
 - (b) for LH Side:
 - (1) Remove the rear seatback board carpet assembly (See page [SE-29](#)).
3. **REMOVE REAR SEATBACK ASSEMBLY**
 - (a) for RH Side:
 - (1) Remove the rear seatback assembly (See page [SE-43](#)).
 - (b) for LH Side:
 - (1) Remove the rear seatback assembly (See page [SE-29](#)).
4. **REMOVE REAR FLOOR BOARD (See page [IR-13](#))**
5. **REMOVE REAR FLOOR MAT SUPPORT PLATE (See page [IR-14](#))**
6. **REMOVE LUGGAGE HOLD BELT STRIKER ASSEMBLY (See page [IR-14](#))**
7. **REMOVE REAR FLOOR MAT ASSEMBLY (See page [IR-15](#))**
8. **REMOVE FRONT DOOR SCUFF PLATE (See page [IR-15](#))**
9. **REMOVE ACCESS DOOR SCUFF PLATE (See page [IR-15](#))**
10. **REMOVE FRONT DOOR OPENING TRIM WEATHERSTRIP**
 - (a) Remove the front door opening trim weatherstrip to the extent that the deck trim side panel and the roof side inner garnish can be removed.
11. **REMOVE DECK SIDE GARNISH (w/ Woofer) (See page [IR-18](#))**
12. **REMOVE SPEAKER MOUNTING COVER (w/ Woofer) (See page [AV-90](#))**
13. **REMOVE AMPLIFIER BOX SPEAKER ASSEMBLY (w/ Woofer) (See page [AV-90](#))**

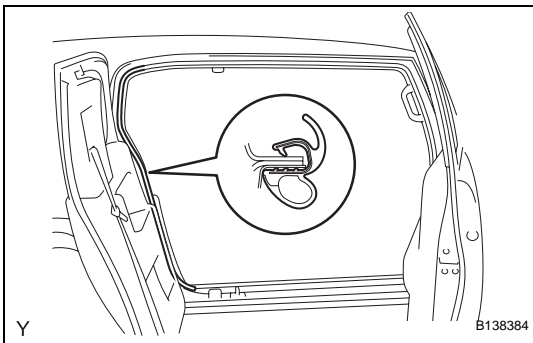

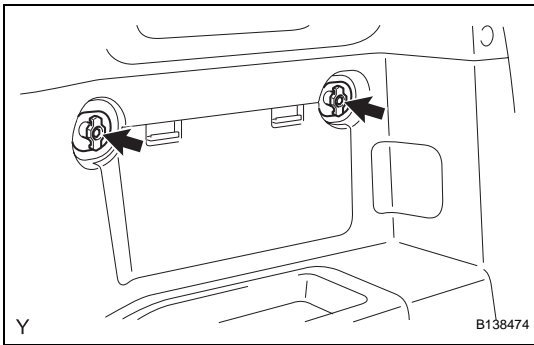

14. REMOVE PACKAGE HOLDER NET HOOK (w/o Woofer)

HINT:

Use the same procedure for both sides.

- (a) Remove the screw and the package holder net hook.

15. REMOVE QUARTER TRIM POCKET TRAY (w/o Woofer) (See page IR-19)

16. REMOVE SIDE TRIM COVER (w/o Woofer) (See page IR-19)

17. REMOVE QUARTER TRIM POCKET (w/o Woofer) (See page IR-19)

18. REMOVE LAP BELT OUTER ANCHOR COVER

- (a) Disengage the 3 claws and remove the lap belt outer anchor cover.

19. REMOVE REAR DECK TRIM COVER (w/ Power Outlet Socket) (See page IR-20)

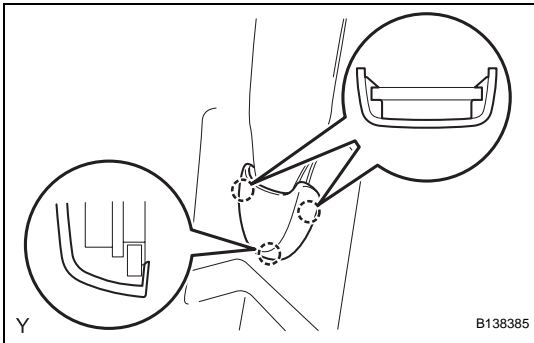

20. REMOVE DECK TRIM SIDE PANEL ASSEMBLY

- (a) Remove the bolt and the anchor plate.

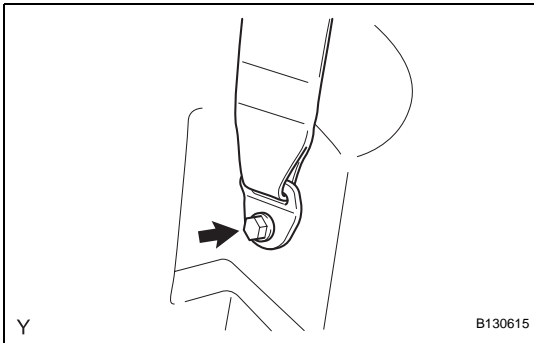

- (b) for RH Side:

- (1) Remove the 4 screws.

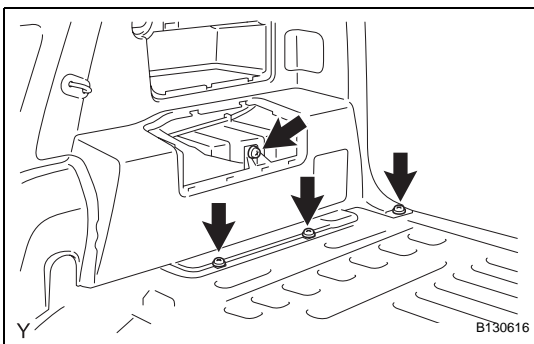

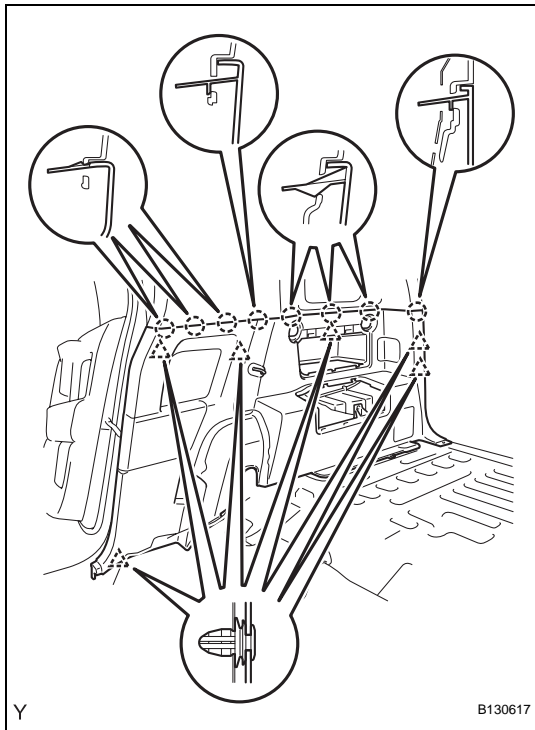

(2) Disengage the 6 clips and the 8 claws and remove the deck trim side panel.

SB

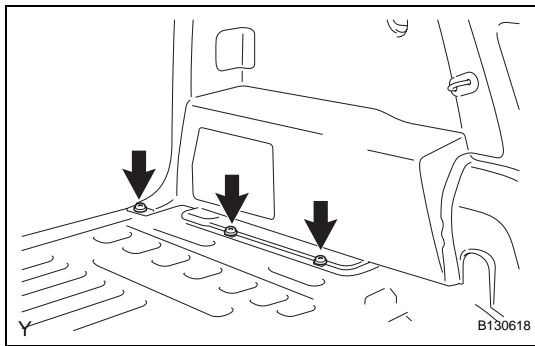

(c) for LH Side:
 (1) Remove the 3 screws.

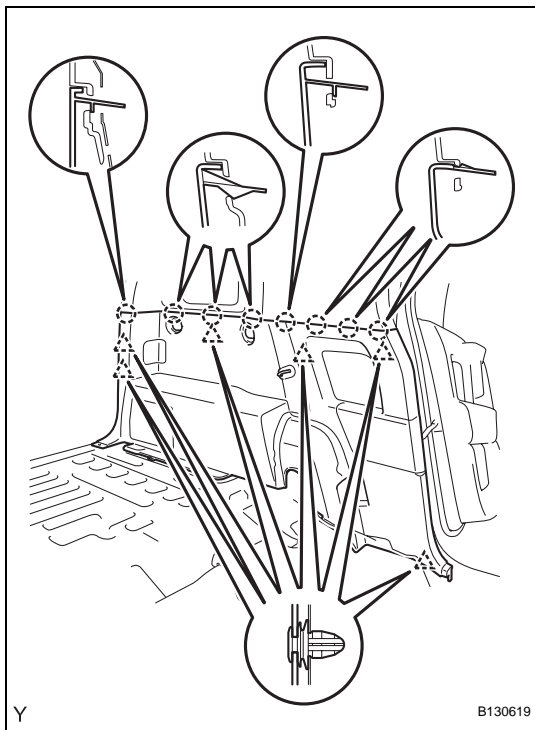

(2) Disengage the 6 clips and the 8 claws and remove the deck trim side panel.

21. REMOVE ROOF SIDE INNER GARNISH (See page IR-22)

**22. REMOVE REAR SEAT OUTER BELT ASSEMBLY**

(a) Remove the bolt and the through anchor.

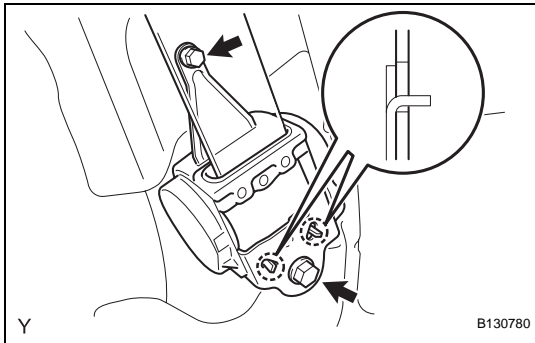

(b) Remove the 2 bolts, 2 hooks and the retractor.