

REAR LOWER CONTROL ARM

COMPONENTS

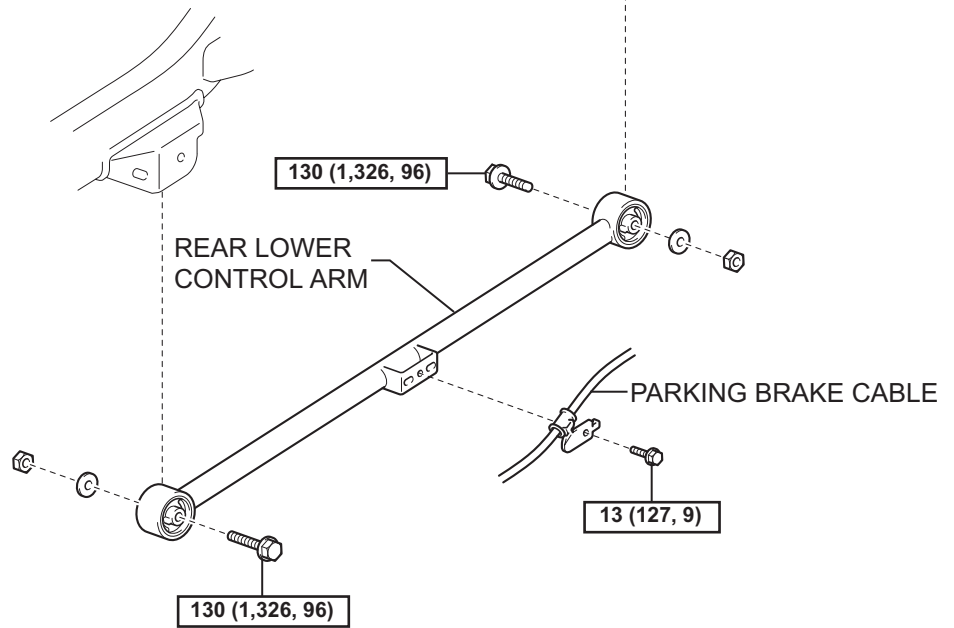
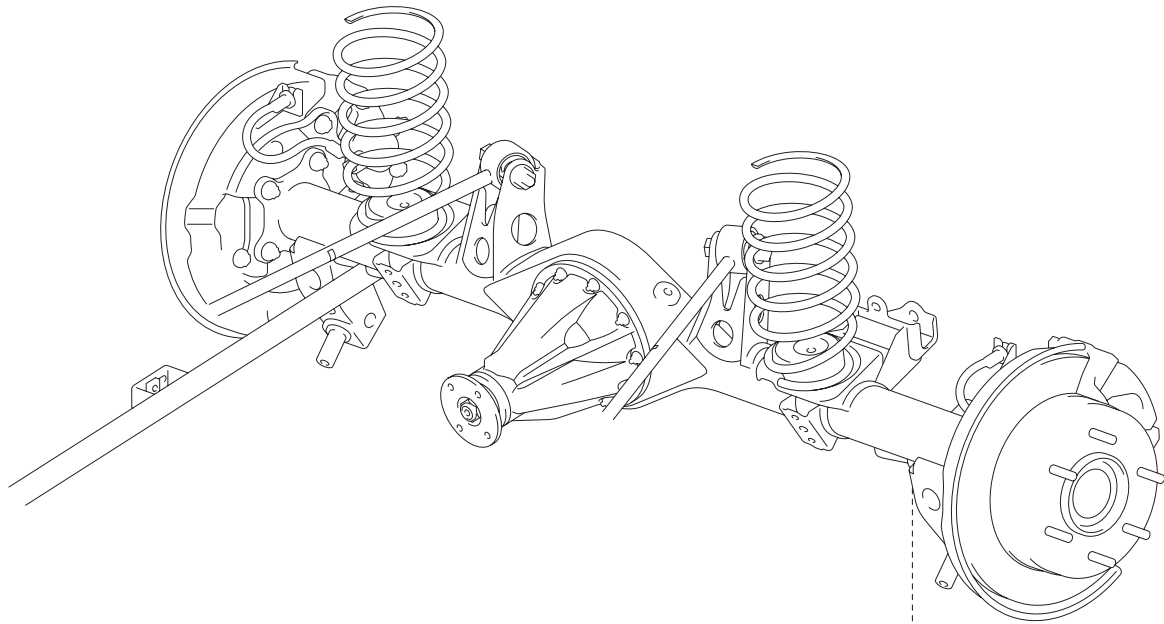

N*m (kgf*cm, ft*lbf) : Specified torque

REMOVAL

1. REMOVE REAR WHEEL
2. SEPARATE PARKING BRAKE CABLE
 - (a) Remove the bolt and separate the parking brake cable.
3. REMOVE REAR LOWER CONTROL ARM
 - (a) Support the rear axle housing.

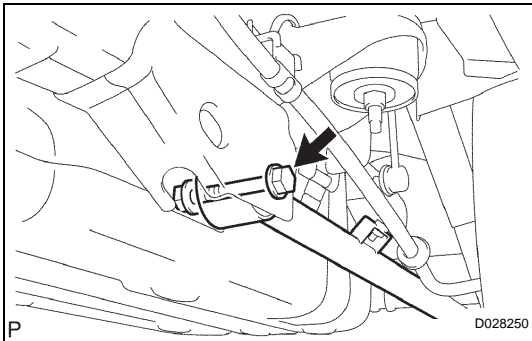
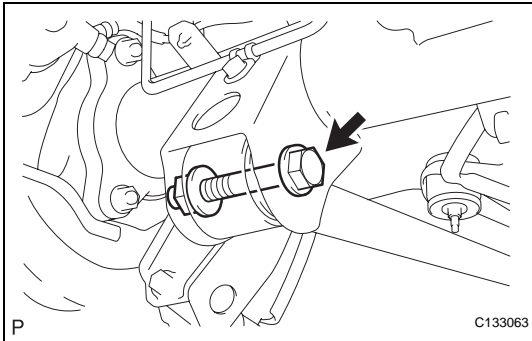
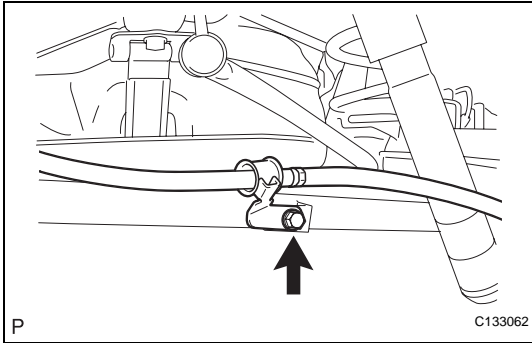

- (b) Remove the bolt, nut and washer.
HINT:
While fixing the nut, turn and remove the bolt.
- (c) Remove the bolt, nut, washer and lower control arm.
HINT:
While fixing the nut, turn and remove the bolt.

INSTALLATION

1. TEMPORARILY TIGHTEN REAR LOWER CONTROL ARM
 - (a) Install the lower control arm, as shown in the illustration.

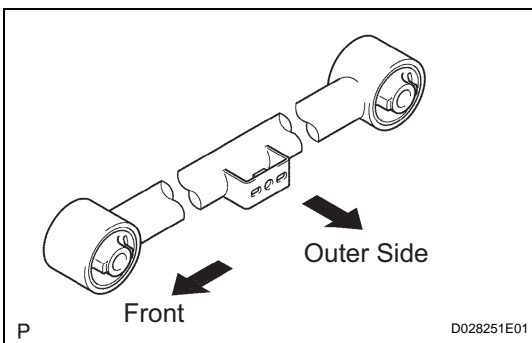

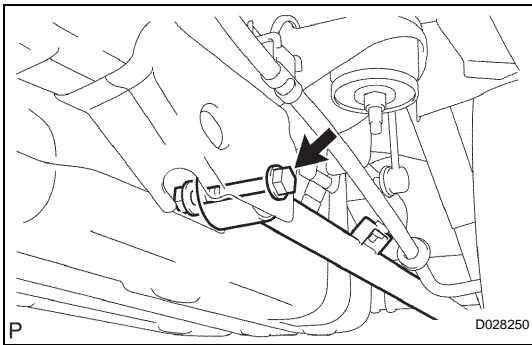

(b) Provisionally tighten the bolt, nut and washer.

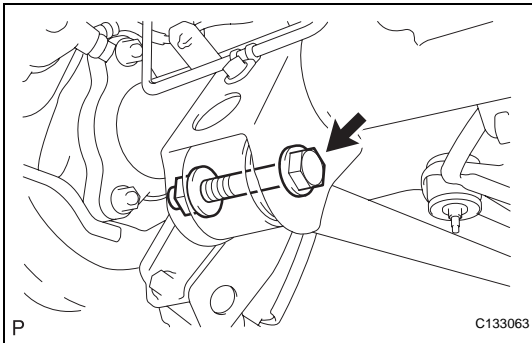

(c) Provisionally tighten the bolt, nut and washer.

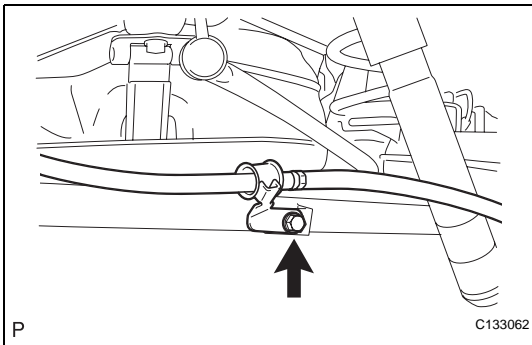

2. INSTALL PARKING BRAKE CABLE

(a) Install the parking brake cable onto the lower control arm.

Torque: 13 N*m (127 kgf*cm, 9 ft.*lbf)

3. INSTALL REAR WHEEL

Torque: 112 N*m (1,137 kgf*cm, 82 ft.*lbf)

4. STABILIZE SUSPENSION

(a) Jack down the vehicle.
 (b) Bounce the vehicle up and down several times to stabilize the suspension.

5. FULLY TIGHTEN REAR LOWER CONTROL ARM

(a) Fully tighten the 2 bolts.

Torque: 130 N*m (1,326 kgf*cm, 96 ft.*lbf)

HINT:

While fixing the nut, turn and install the bolt.

