



Equipped with *AEM DRYFLOW* Filter
No oil Required!

Kit Part Number: 21-9211

2003-2006 Dodge Ram 5.9L Cummins Diesel CARB EO # D-392-29

Brute Force HD Intake Systems that are pending an Executive Order number (EO#) relating to exemptions under Section 27156 of the Vehicle Code from the California Air Resource Board (CARB) are for off-road use only in California, which may never be used on public highways.

© 2008, Advanced Engine Management, Inc. AEM is a registered trademark of Advanced Engine Management, Inc. All Rights Reserved.



Advanced Engine Management Inc.
2205 126th Street, Unit A
Hawthorne, CA 90250
Phone: 310.484.2322
<http://www.aempower.com>

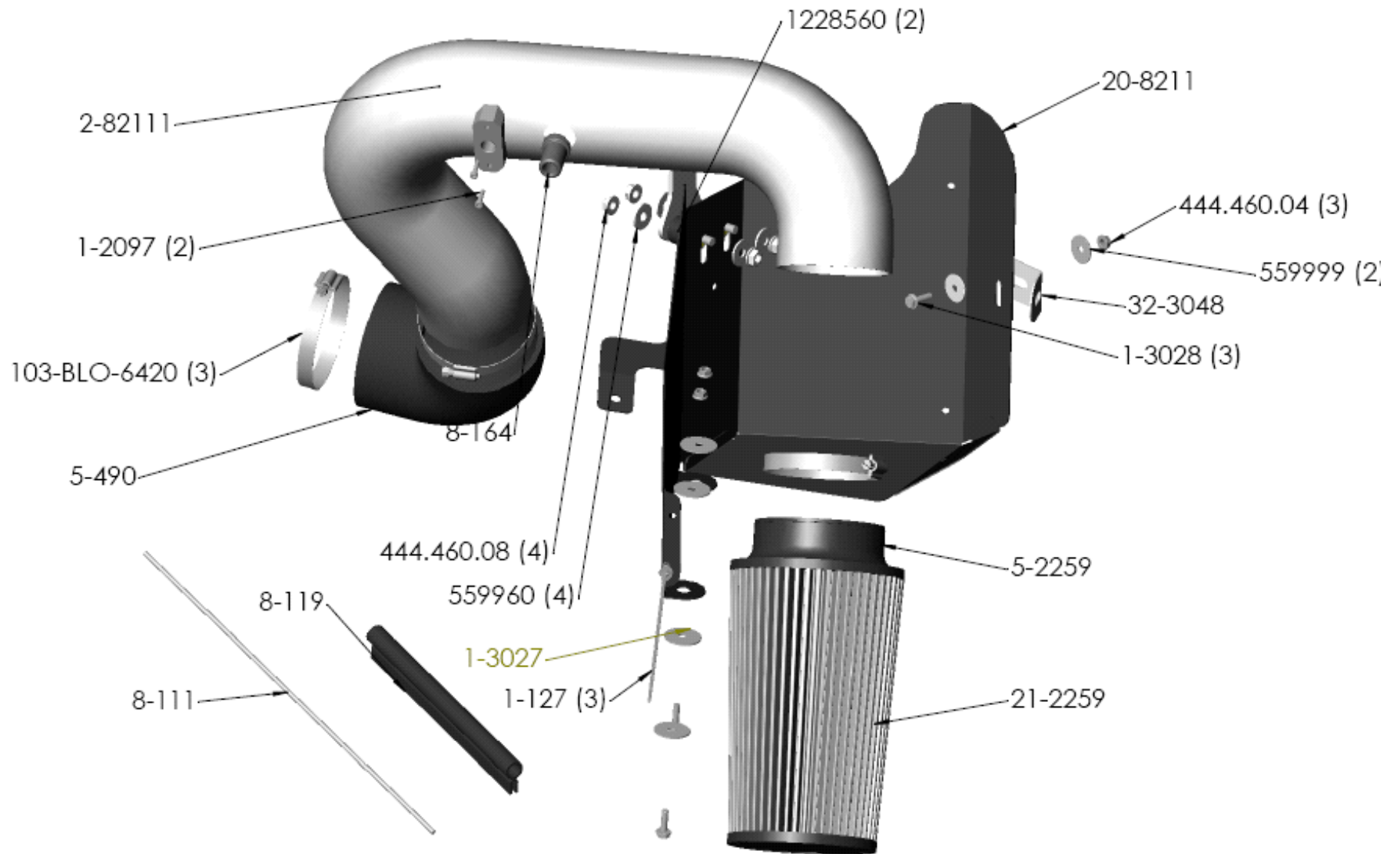

BILL OF MATERIALS

Quantity	Part Number	Description
1	2-82111	Inlet Pipe
1	20-8211	Heat Shield
1	32-3048	Bracket, Heat Shield
1	5-490	Elbow, 4" 90 Degree
3	103-BLO-6420	#64 Hose Clamp
2	1228560	Rubber Mount, M8
4	559960	Washer, M8
4	444.460.08	Nut, M8
3	1-2038	Bolt, M6 x 20
2	559999	Washer, M6
3	444.460.04	Nut, M6
2	1-2097	Bolt, M4 MAF
4	1-3027	Washer, 1-1/4" Flat
20"	8-111	Rubber Edge Trim
12"	8-119	Sponge Rubber Gasket
1	21-2259D	Air Filter, 9" Brute Force HD
1	5-2259	Air Filter Adapter
1	8-164	Adapter, Nipple
3	1-127	Zip-Tie, Tree Mount
2	10-922BFHDV	Brute Force HD Emblem
1	10-8211	Instructions

1. Preparing Vehicle

- a) Make sure vehicle is parked on a level surface.
- b) Set parking brake.
- c) If engine has run in the past two hours, let it cool down.
- d) Disconnect negative battery terminals.
- e) Do not discard stock components after removal of the factory system.

Recommended Tools:

- 5/16" Nut Driver
- 10mm & 13mm Socket
- Ratchet
- Extension
- 10mm Wrench

Installation Time: 1.5 hours

2. Removal of Stock System



a) Stock intake system. Unplug the wiring harness from the Inlet Air Temperature (IAT) sensor.



b) Loosen the hose clamps securing the flexible inlet hose between the turbo inlet and the air filter housing. Remove the hose.



c) Remove the nut securing the front of the air filter housing to the chassis. Lift up on the air filter housing and remove it from the engine bay.



d) Remove the grommets from the plastic battery tray. Remove the bolt securing the battery tray to the fender.



e) Remove the bolt securing the radiator shroud to the radiator as shown. Note: 03-04.5 models have a different radiator than the 04.5+ models. May differ from picture shown.



f) Remove the factory air filter restriction gauge and the IAT sensor from the stock air filter housing.

3. Installation of Brute Force HD Intake System

- a) When installing the intake system, **DO NOT** completely tighten the hose clamps or mounting tab hardware instructed to do so.



b) Stock intake system removed

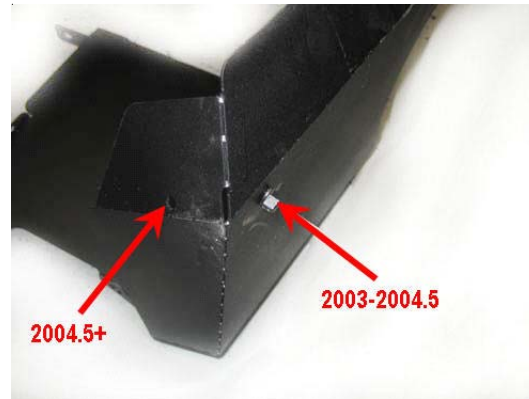

c) Install one supplied tree mount zip-tie into the hole on the heat shield bottom as shown. On earlier models (03-04.5), install the lower zip-tie in the hole on the side of the heat shield.



d) Install the remaining two zip ties into the two remaining holes in the heat shield.



e) Install the supplied rubber edge trim onto the top edge of the heat shield



f) Install the two rubber mounts into the two holes on the heatshield using the supplied M8 washers and nuts. Do not tighten the nuts.



g) Install the front heat shield mount using the supplied M6 nut and bolt and using the two smaller flat washers. The bracket will need to align with the removed bolt from step 2e.



h) Install the heat shield by aligning the two holes on the bottom with the two larger holes on the battery tray. Secure using the two supplied M6 bolts and nuts, and four flat washers.



i) Reinstall the bolt from step 2e) to secure the front heat shield mount.



j) Align the small mounting tab with hole where the bolt was removed in step 2d. Reinstall the bolt, securing the heat shield to the top of the fender.



k) Use the installed zip-ties to secure the battery cable, washer bottle hose, and AC hose to the heat shield. Trim excess plastic.



l) Install the IAT sensor into the intake pipe using the two supplied MAF bolts.



m) Install the nipple onto the pipe (use soapy water to aid installation). Place the nipple into the pipe at an angle and rotate it until the groove engages the pipe. Install the previously removed air filter restriction gauge into the nipple.



n) Secure the coupler to the turbo-charger using a #64 hose clamp but do not fully tighten the clamp yet.



o) Install the intake pipe by sliding the pipe into the elbow installed on the turbo inlet.



p) Align the mounting bracket on the pipe with the two rubber mounts on the heat shield. Install the remaining M8 washers and nuts to secure.



q) Plug the IAT sensor into the wiring harness as shown. Be sure the harness is away from the exhaust manifold.



r) Install the supplied air filter adapter by stretching it over the end of the pipe.



s) Install the Brute Force HD Dryflow filter onto the filter adapter. Rotate the filter until it is not touching any part of the vehicle and secure it using the remaining #64 clamp.



t) Check that the pipe is centered in the heat shield hole. Once confirmed, tighten the nuts on the bracket and the hose clamps on the pipe and turbo.

**Before****After**

4. Re-assemble Vehicle

- a) Position the inlet pipe for best fitment. Be sure that the pipe or any other components do not contact any part of the vehicle they are not supposed to. Tighten the rubber mounts, all bolts and hose clamps.
- b) Install the rubber gasket onto the top edge of the heat shield and trim the excess. This seals the hood to the heat shield. Check for proper hood clearance. Readjust pipes if necessary and retighten them.
- c) Inspect the engine bay for any loose tools and check that all fasteners that were moved or removed are properly tight.
- d) Reconnect negative battery terminals and start the engine. Let car idle for 3 minutes. Perform a final inspection before driving vehicle.

5. Service and Maintenance

- a) It is recommended that you service you AEM dryflow filter every 20,000 miles for optimum performance. Use AEM Dryflow cleaning kit part #21-110.
- b) Use aluminum polish to clean your polished AEM Brute Force HD intake pipe.
- c) Use window cleaner to clean your powder coated AEM Brute Force HD intake pipe.

NOTE: DO NOT USE ALUMINUM POLISH ON A POWDER COATED AEM BRUTE FORCE HD INTAKE PIPE.

For technical inquires
e-mail us at
tech@aempower.com
or
call us at
310.484.2322 Option #3

AEM Air Intake System Warranty Policy

AEM warrants that its intake systems will last for the life of your vehicle. AEM will not honor this warranty due to mechanical damage (i.e. improper installation or fitment), damage from misuse, accidents or flying debris. AEM will not warrant its powdercoating if the finish has been cleaned with a hydrocarbon-based solvent. The powdercoating should only be cleaned with a mild soap and water solution. Proof of purchase of both the vehicle and AEM intake system is required for redemption of a warranty claim.

This warranty is limited to the repair or replacement of the AEM part. In no event shall this warranty exceed the original purchase price of the AEM part nor shall AEM be responsible for special, incidental or consequential damages or cost incurred due to the failure of this product. Warranty claims to AEM must be transportation prepaid and accompanied with dated proof of purchase. This warranty applies only to the original purchaser of product and is non-transferable. Improper use or installation, use for racing, accident, abuse, unauthorized repairs or alterations voids this warranty. AEM disclaims any liability for consequential damages due to breach of any written or implied warranty on all products manufactured by AEM. Warranty returns will only be accepted by AEM when accompanied by a valid Return Merchandise Authorization (RMA) number. Credit for defective products will be issued pending inspection. Product must be received by AEM within 30 days of the date RMA is issued.

If you have a warranty issue, please call (310) 484-2322, extension 203 and our customer service department will assist you. A proof of purchase is required for all AEM warranty claims.